

N.E. Cor. 20 T-74N R-18W

Found stone

Set CM.

N. E Cor 20 T-74N R-18W

59

Set 12-2-39 sketch by
By Ray Wandell Ingnall
and Party

Notes: Fd. Conc. Mon w/ Brass Cap on North
facing timbered slope about 6" deep
+ having a steel post by it

• = 5/8" x 40" Rebar Blue plastic IDOT Ref. Cap
Set flush w/ ground surface

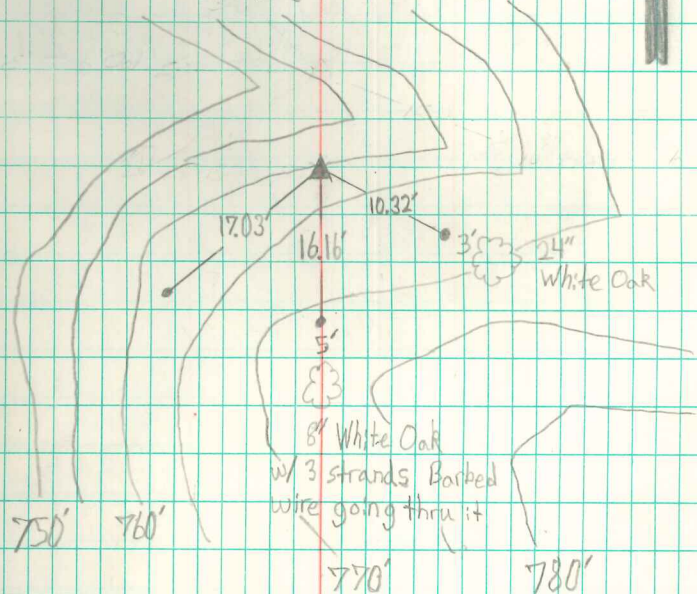

Retied 1/26/11
David Brown