

Instr. Number: 24-637
 BK: 2024 PG: 637
 Recorded: 2/21/2024 at 12:38:27.0 PM
 County Recording Fee: \$7.00
 Iowa E-Filing Fee: \$3.00
 Combined Fee: \$10.00
 Revenue Tax: \$0.00
 NAOMI ELLIS, RECORDER
 Marion County, Iowa

TRIPLE R ENGINEERING | Ronda L. Cink | 2454 601st TRAIL, ALBIA, IOWA 52531 | PHONE: (515) 230-8683

UNITED STATES PUBLIC LAND SURVEY CORNER CERTIFICATE

Land Survey Monuments situated in Section 34, Township 74 North, Range 18 West, of the Fifth Principal Meridian, Marion County, Iowa. Previously recorded in (Not Previously Recorded) in County Recorder's Office.

(Show reason for preparing this certificate, the evidence and detailed procedures used in establishing the corner positions and monuments found or placed)

MONUMENT DESCRIPTION AND REMARKS:

NE Corner of the SW Qtr. of the SW Qtr. Searched the area and did not find an existing monument. Searched at the West Qtr. Corner, Southwest Corner, and South Qtr. Corner and did not find any monuments in those locations either. Decided fence was the best available evidence of the location of this section corner. Set 1/2" iron pin with purple cap at the intersection of an East - West fence with a fence from the South.

SE Corner of the SW Qtr. of the SW Qtr. Searched the area and did not find an existing monument. Searched at the West Qtr. Corner, Southwest Corner, and South Qtr. Corner and did not find any monuments in those locations either. Decided fence was the best available evidence of the location of this section corner. Set 1/2 inch iron pin with purple cap at a three-way fence corner post.

**NE Cor.
SW - SW**

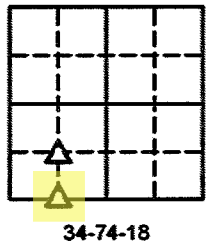
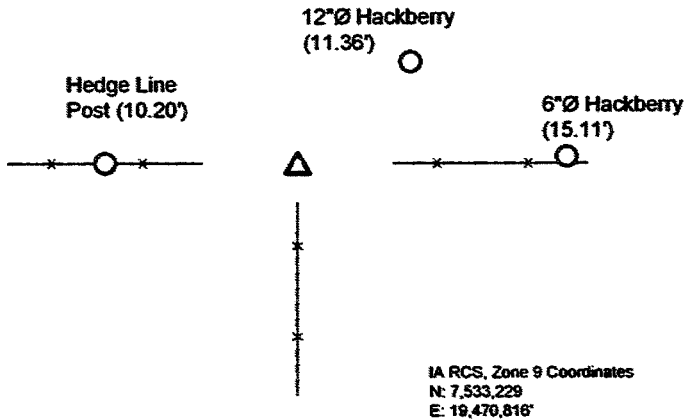

All ties 1 1/2" plastic washer set with mag nail facing monument unless noted

**SE Cor.
SW - SW**

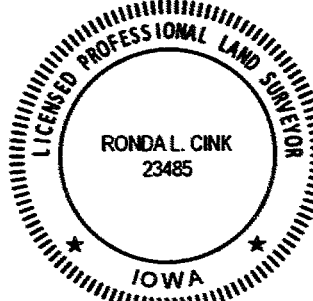
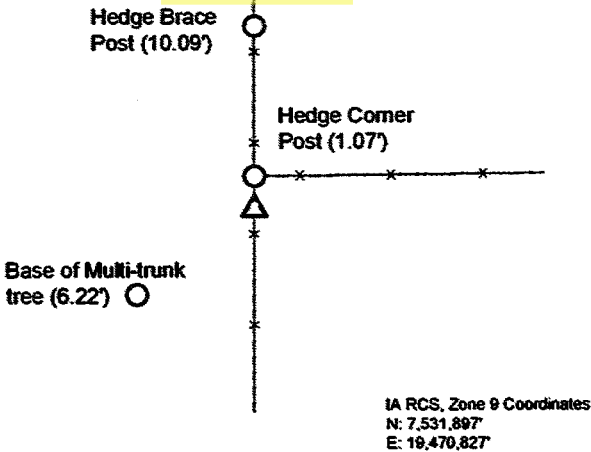

I hereby certify that this land surveying document was prepared by me or under my direct personal supervision and that I am a duly licensed Land Surveyor under the laws of the State of Iowa.

Ronda Cink
 Ronda Cink
 2024.02.21 12:29:19 -06'00'
 Ronda L. Cink PE & PLS Registration No. 23485

Date: 02/21/2024
 My registration renewal date is December 31, 2025.
 Pages covered by this certification: Page 1

CC#23-065

CORNERS TO BE INDEXED

CORNER	SECTION	TWP	RANGE
NE Cor. SW/SW	34	74N	18W
SE Cor. SW/SW	34	74N	18W