

Found 2 sand stones large one  
was 14"x8"x4" over 2-2" D tile

set c.m. over one tile lowered  
in place. small stone on East  
side mon.

Large stone on top c.m. sticking  
above surface

N<sup>4</sup> Corner Sec. 7-74-18

Found 4"x4" WPA concrete monument using County  
Engineers Office records. No certificate found

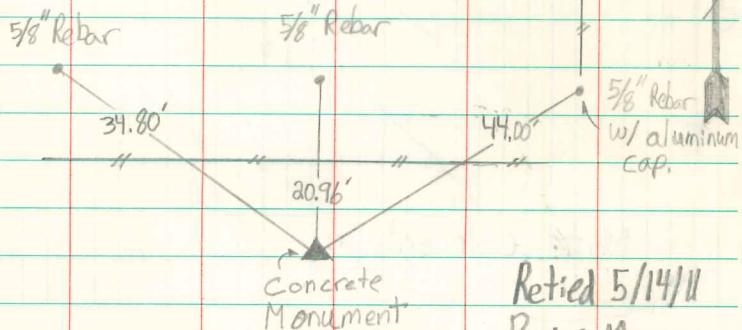

Retied 5/14/11  
Brian Morrissey

N<sup>1</sup>/<sub>4</sub> Cor 7-74-18

Set-14-4-42

Notes: Kennedy

Party = Shors-Luther

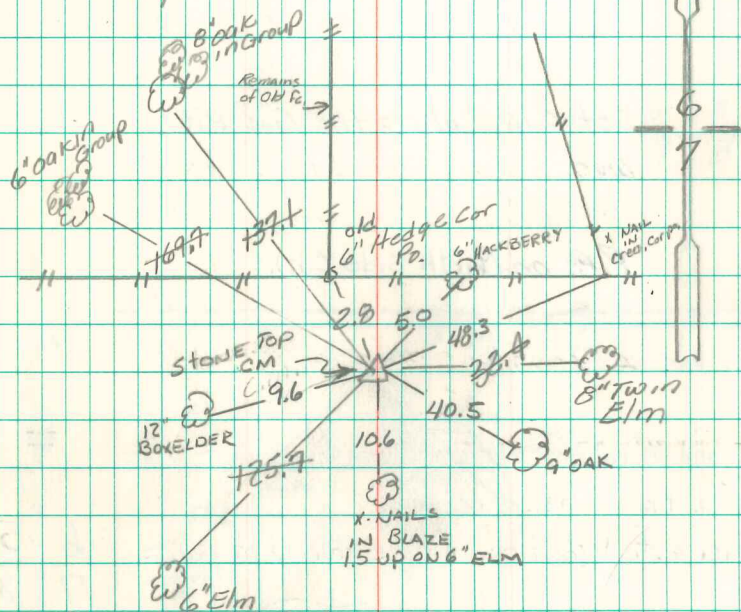

FOUND & RETIED BY  
GARDEN ENG. 6 MAY 1987  
Set 3/4" X 30" Pipe ON  
N. Side Stone

Note: Current Tie