

Found witness Cor. set by N.J. Watkins
 Consisting of 2-8" Q. Tile in vertical position
 & 1-2" Q. Tile leaning over, at a Point
 No. 5. South Found old Pine Stake Set
 over 1-2" Q. Tile in vertical position
 1-2" Tile broken & laying over vertical
 Tile with 5"x10"x15" yellow sandstone
 at side of stake

Lowered 1-2" Q. Tile Directly beneath
 orig. Position, Set c.m. over tile
 Placed 5"x10"x5" sandstone over c.m.
 Broken tile & old stake N. side c.m.

2639.0' W. of c.m. at NE cor 13
 2655.0' E. " c.m. " N $\frac{1}{2}$ " " 14
 2652.0' N. " c.m. " E $\frac{1}{2}$ " " 14

NE. Cor 14-74-19
 Set - Aug-12-1948
 Notes - Kennedy
 Party = Barker, Mandell, Frazier & Keith

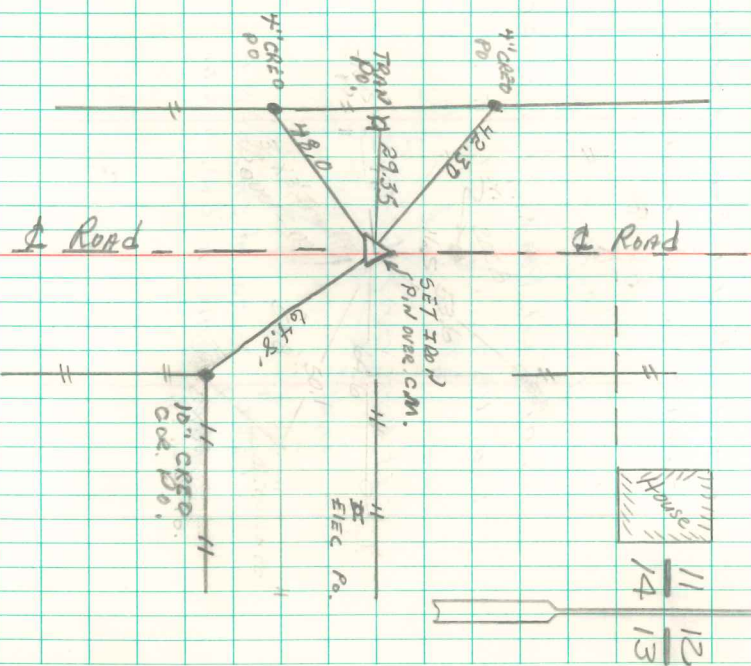

RETI'D BY
 ADIE DRY.5
 2/10/92