

N¹/₂ Cr 23-74-19

Je F-9-14-39

Notes: Original

Party - Kennedy - Elberry

Found Sand Stone 8' x 5' x 3" &
2-2' D. Tile

Set C.M over Broken Tile & 1-2"

D. Tile.

Set Sand Stone Top North side

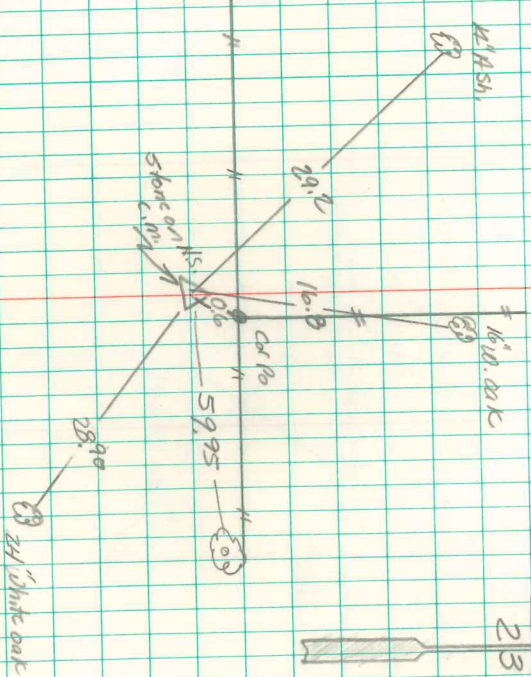
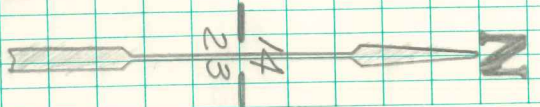

Found Conc. Mass 12" deep, set 5/8" iron pin on
top, 3" above ground, set 5/16" on E. side
30" above ground, Able Davis 12/6/99