

Dug hole 2'x2" & Found Angle Iron  
26" Long in Center of Road

set c.m. over 1-2" Q. tile & Put  
Angle Iron on North side c.m.

N.E. Cor sec G-74-19

Set - July - 1 - 1942

Notes: Kennedy

Party = Palmer, Moss, & Truman

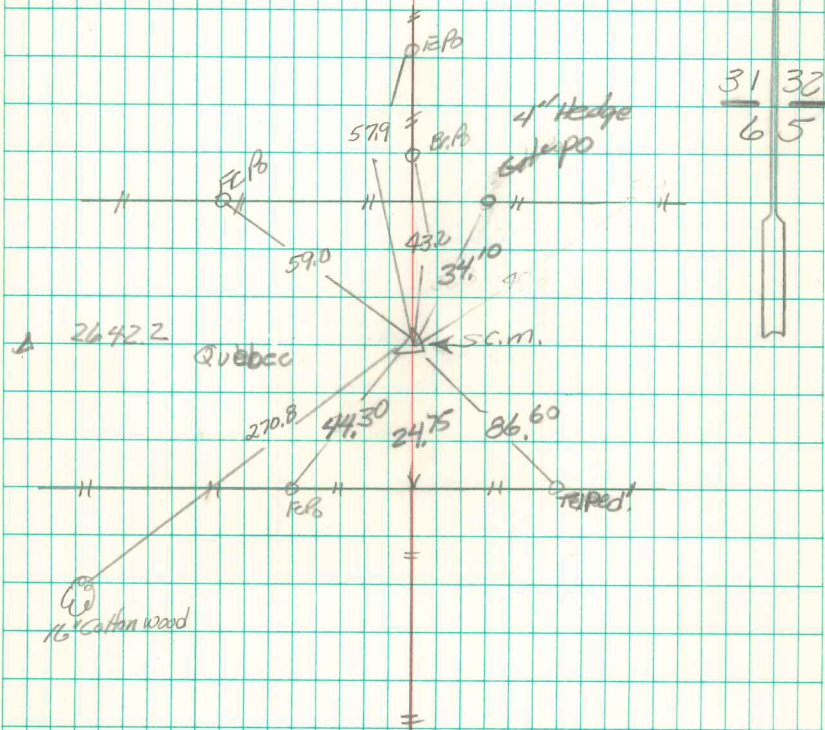

Find Angle Iron pin  
set 5/8" iron pin w/cap

6/8/04 Abie Davis