



Document 17-4757

Book 2017 Page 4757 Type CORNR Pages 1

Date 10/27/2017 Time 10:13 AM

Rec Amt \$7.00

KAREN SCHWANEBECK, RECORDER
MARION COUNTY IOWA

Prepared by Abie C. Davis, P.E. & L.S., 1428 Oregon St., Knoxville, IA 50138 (641) 842-5863

UNITED STATES PUBLIC LAND SURVEY CORNER CERTIFICATE OF

Land survey Monuments situated in Section 35, Township 74N, Range 20W of the Fifth Principal Meridian, Marion County, Iowa.

Previously recorded in N/A in County Recorders Office.

(book, page, document number, etc.)
Show reason for preparing this certificate, the evidence and detailed procedures used in establishing the corner positions and monumentation found or placed

Monument Description and Remarks: Found Iron Pin
at location of ties from County Engineer's
office. set out new ties.

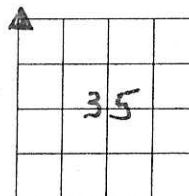

PLAN - VIEW

(Show a minimum of three reference ties to durable physical objects, relevant monuments and physical conditions that will enable recovery of the corner.)

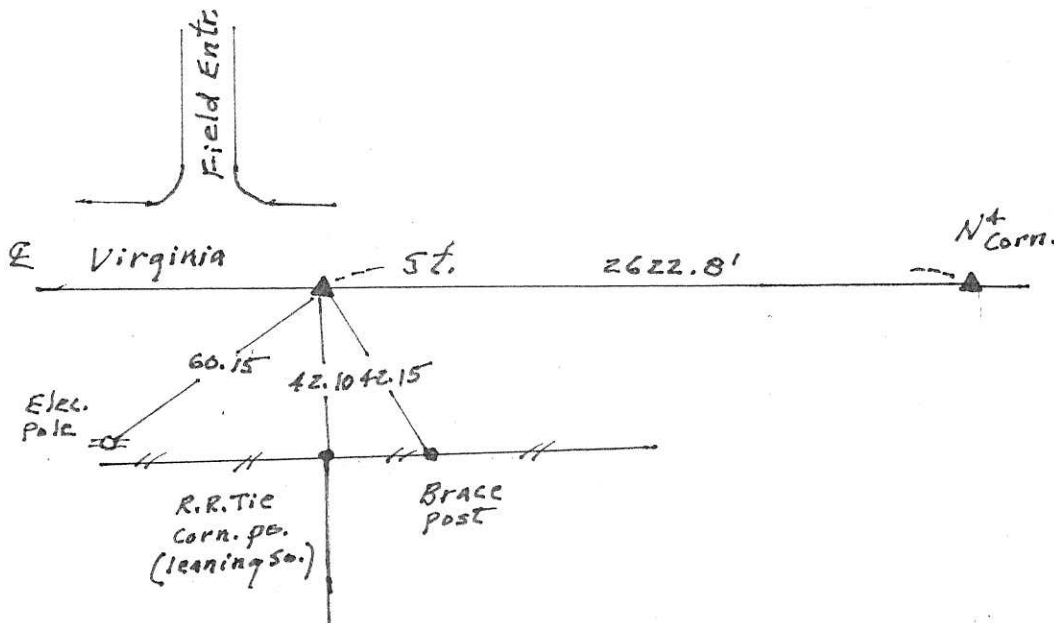

I hereby certify that the survey work was completed and this land surveying document was prepared by me or under my direct personal supervision and that I am a duly licensed land surveyor under the laws of the state of Iowa

Signature: Abie C Davis

Date: 10/26/2017 Abie C. Davis, P.E. & L.S. Reg. No. 5594

My license renewal date is December 31, 2017

SEAL

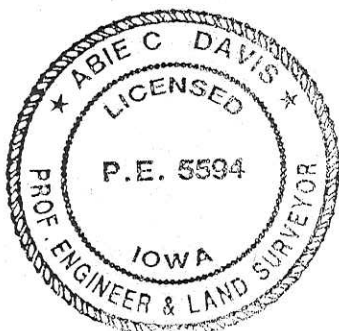

List Corners to be Indexed			
Corners	Section	Twp	Range
NW	35	74N	20W

Pd \$100 Cash - Ret Abie Davis

Found large sandstone 20"x14"x9"
standing on end, right where
we set mon. as shown in description.

Set mon. over 2-2" horse shoe
tike standing on end.

Put the stone on top mon.
Top of stone 10" under
surface, cm. about 4' under
road surface.

N.E. cor. 34. 7A-20

Set 8-15-41

Notes: Kennedy

Party: Kennedy,
Shore, Luther.

