

Dug hole along fence rows
North and East and South west,
found no evidence, except stone
laying in fence corner. Established
corner on line N. & S. between Sec.
corners and on Fence lines E. & W.
on prop. dist from West.

Set C.M. stone over C.M.

E 1/4 cor 5 - 74-20

Set August 5, 1941

Party: Mandell, Frazier Notes: Kennedy

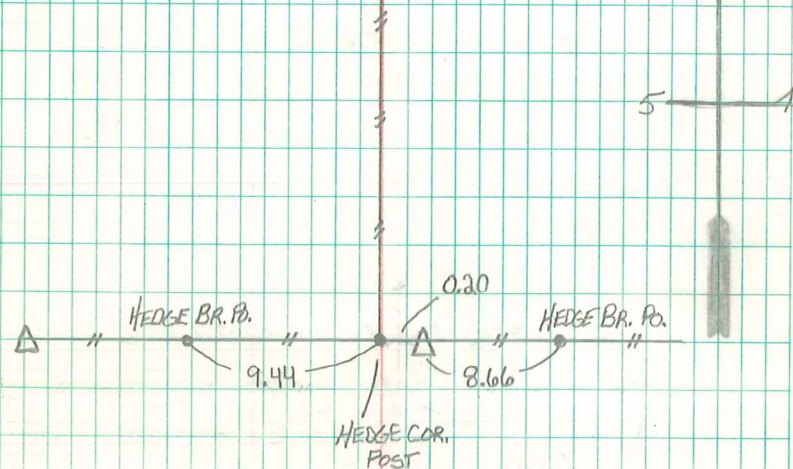

RE-TIED 3/19/13

BRIAN MORRISSEY