



Document 18-302

Book 2018 Page 302 Type CORNR Pages 1
Date 1/22/2018 Time 10:06 AM
Rec Amt \$7.00

KAREN SCHWANEBECK, RECORDER
MARION COUNTY IOWA

Prepared By: J. Brian Morrissey, Morrissey Surveying & Consulting, LLC, 1405 Hwy. G28, Otley, Ia. 50214, 515-480-2531

UNITED STATES PUBLIC LAND SURVEY CORNER CERTIFICATE OF

Land Survey Monuments situated in Section 11, Township 74N, Range 21W, of the Fifth Principal Meridian, Marion County, Iowa.
Previously recorded in N/A in the County Recorder's Office.
(book, page, document number, etc.)

(Show reason for preparing this certificate, the evidence and detailed procedures used in establishing the corner positions and monumentation found or placed.)

Monument Description and Remarks: Found 1" pipe 15" deep as per County Engineer's Office field book tie records. Accepted position. No Previous Certificate of record.

This Corner was used for a Plat of Survey in the NW 1/4 of Sec. 11, recorded in Bk. 2016, P. 5290.

PLAN VIEW

(Show a minimum of three reference ties to durable physical objects, relevant monuments and physical conditions that will enable recovery of the corner.)

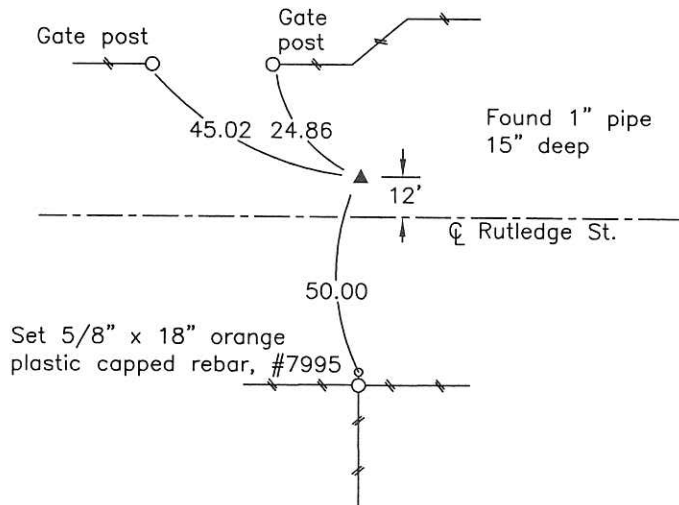
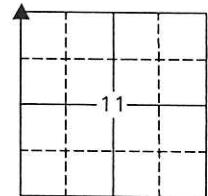

NW Corner, Section 11

Date of Survey: 9/23/16

NOTE: ALL TIES TO BRASS DISK OR YELLOW/ORANGE SURVEY MARKER UNLESS NOTED.



I hereby certify that this land surveying document was prepared and the related survey work was performed by me or under my direct personal supervision and that I am a duly Licensed Land Surveyor under the laws of the state of Iowa.

Signature: J. Brian Morrissey Date: 1/22/18
J. Brian Morrissey

License number 7995.
My license renewal date is December 31, 2019

881-16-1/4

R187405 ck - Ref Brian Morrissey

N.E. Cor. 10 T74N R21W.

4

set 5-1-40 (Snow Flurries) sketch by

By Howard Kennedy Wignall

Lawrence Ogden

Leon Shore

Ab. Eddinger

N

$\frac{32}{1011}$

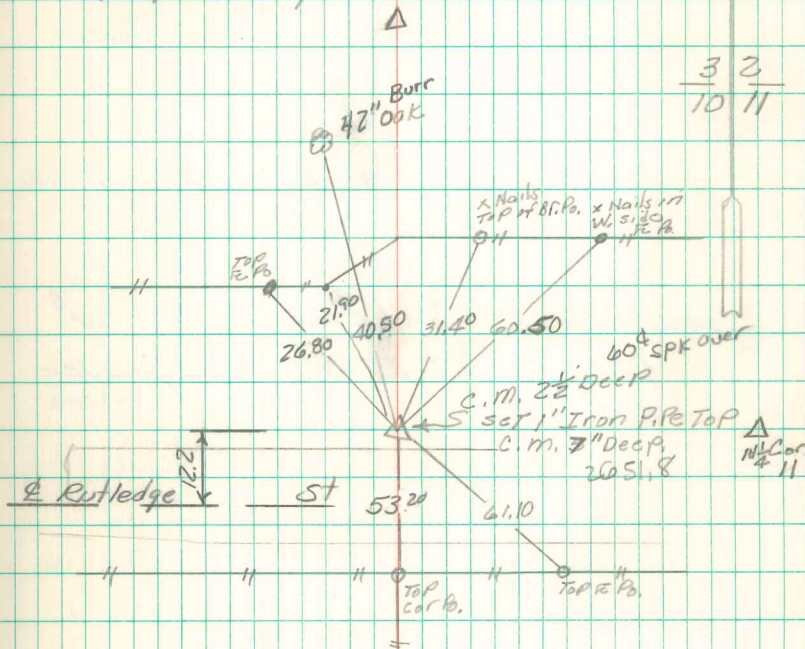

Ret'ed 11-3-71

7-12-01