

Found witness Stone, Painted 6"-10'
Granit Rock on END, over Sandstone

50' West of True Cor, on old Fence
Line. Found stones set on former
S. West

True Cor. is on bank slope of
Gardel Ditch & evidently stone
has been cut or eroded out. Found
remains of old oak round stake.

50' East of Witness Stone. Used this
Evidence & Measurements from
N.S. & W. & Line N. & S. Between See Cor

Set map over 12" O Tile Granit Rock
6" x 8" x 12" on top map.

50.0 Ft. E. of Sandstone 1st. below surface
with Granit Rock over.
33.6' S.W. of x N. in 12" Br. Oak Tree Root
55.2' S.E. " " " 24" " " "
45.8' N.E. " " " 18" " " "
64.8' N.E. " " " 8" " " "
38.5' SW. of Twin 16" oak stumps
124.5' S. 15° E. of Cen of S. END of Bridge

Edge Cor Sec 13-74-21
Set 9-17-21
No T.S.I. Kennedy, Wells, Glass
& Luther.

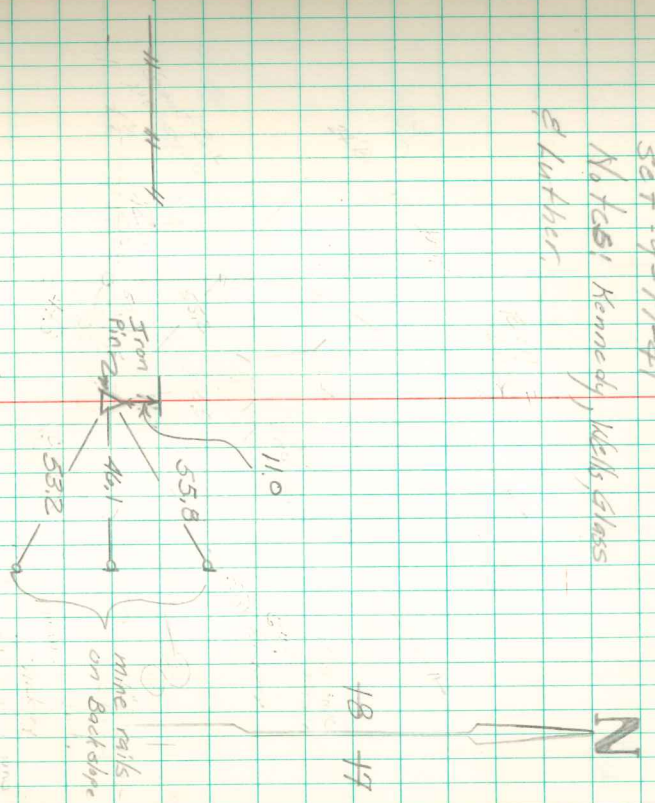

Road rebuilt in 1989.
C.M. pushed out
Set 1/4" iron pin where
Stone was
Found & Retired
July 4, 1937
P. G. on, hand letter
out

SEC can Stone
2666