

E 1/4 Cor Sec 28-74-21

Set 9-11-41

Notes: Kennedy - Stone, Lumber

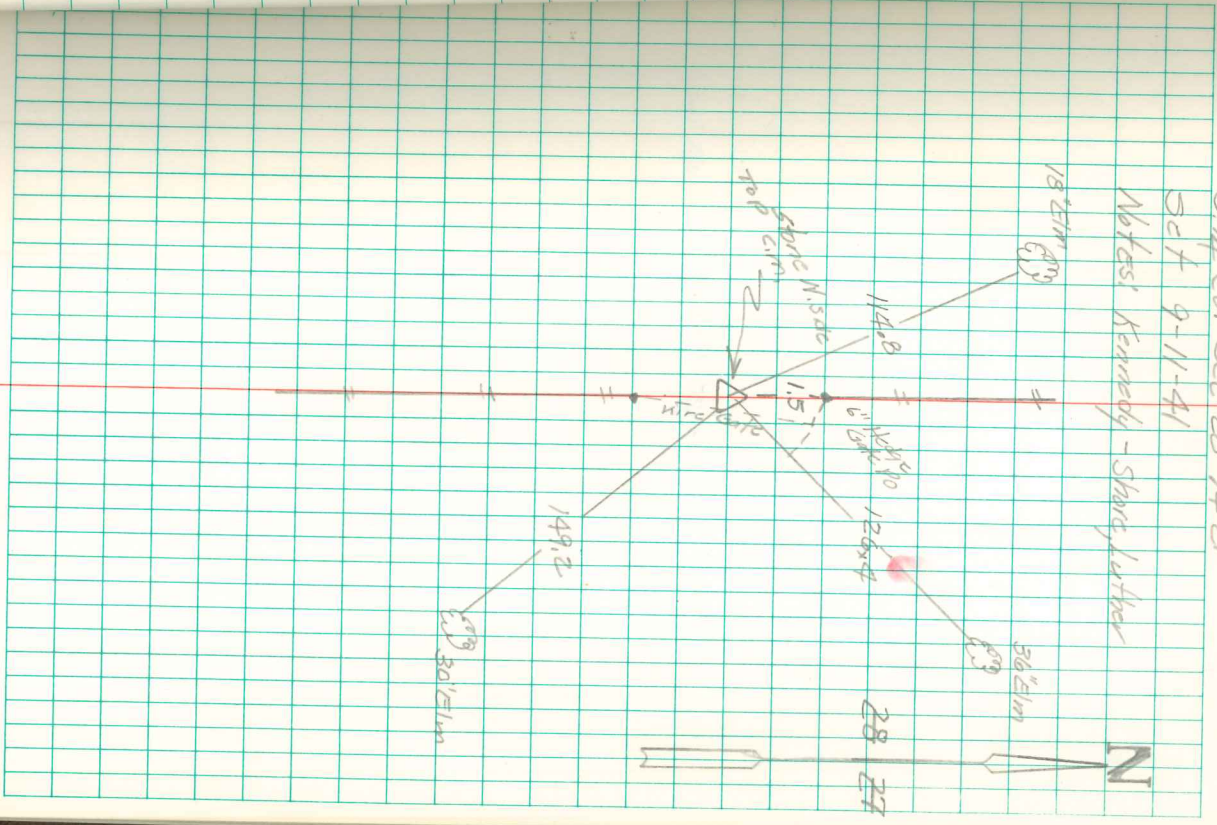

Found sandstones 15" x 13" x 8"

The top stone 20" under top

surface, the farmer had it

used for brace for cor. Gate Post

Set C.M. over 2.2" Horse shoe tile

standing on END.

Stone on N. side Mon top stone 6"

under surface.

2615.5' From C.M. on rd North

2673.3' North of C.M.

1356.0' " " 1/2 Fence

1325.5' South " 1/2 Fence

149.2' NW. of X Nails in 30" Elm Trace

114.8' S.E. " " " 18" " "

126.4' S.W. " " " 36" " "

1.5' South of Gate Post