

N<sup>1</sup>/<sub>2</sub> Cor Dec 29-74-21

Set 4-1-40

Notes: J. Wignall

Wells & Shore

Anderson, M. Howell

33

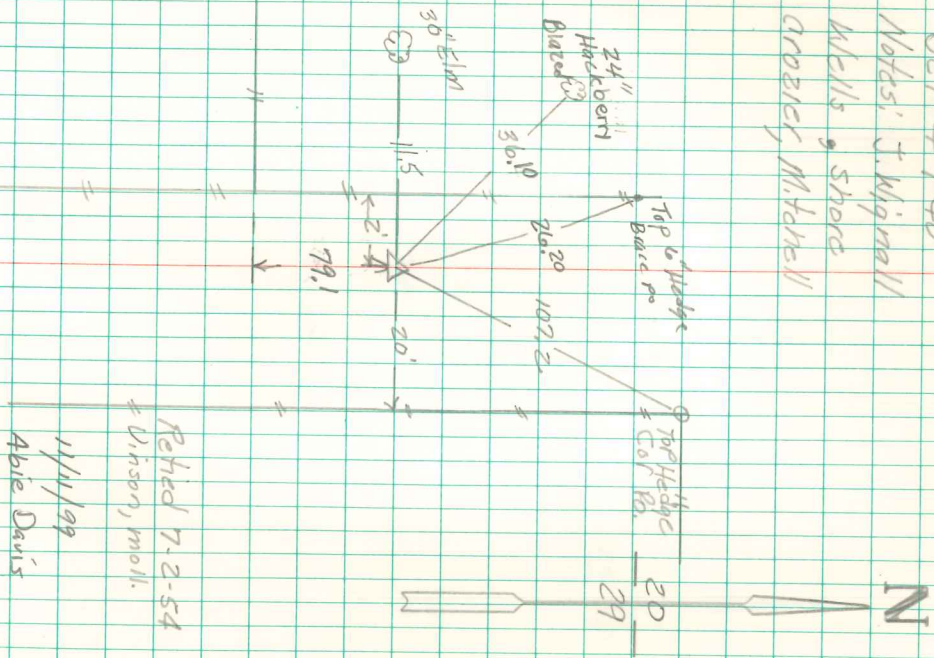

Revised 7-2-54  
# Wilson, moll.

11/1/99  
Abie Davis

Found Stone 8" x 18" x 2" and 1-2" Ties

Set C.M.

Did not find CM, set 5/8" iron pin w/ cap  
from existing 1954 ties. Abie Davis