

N.E. Cor. Sec 29-74-21

Set 9-12-41

Notes: Kennedy

Wells Glass & Bigelow

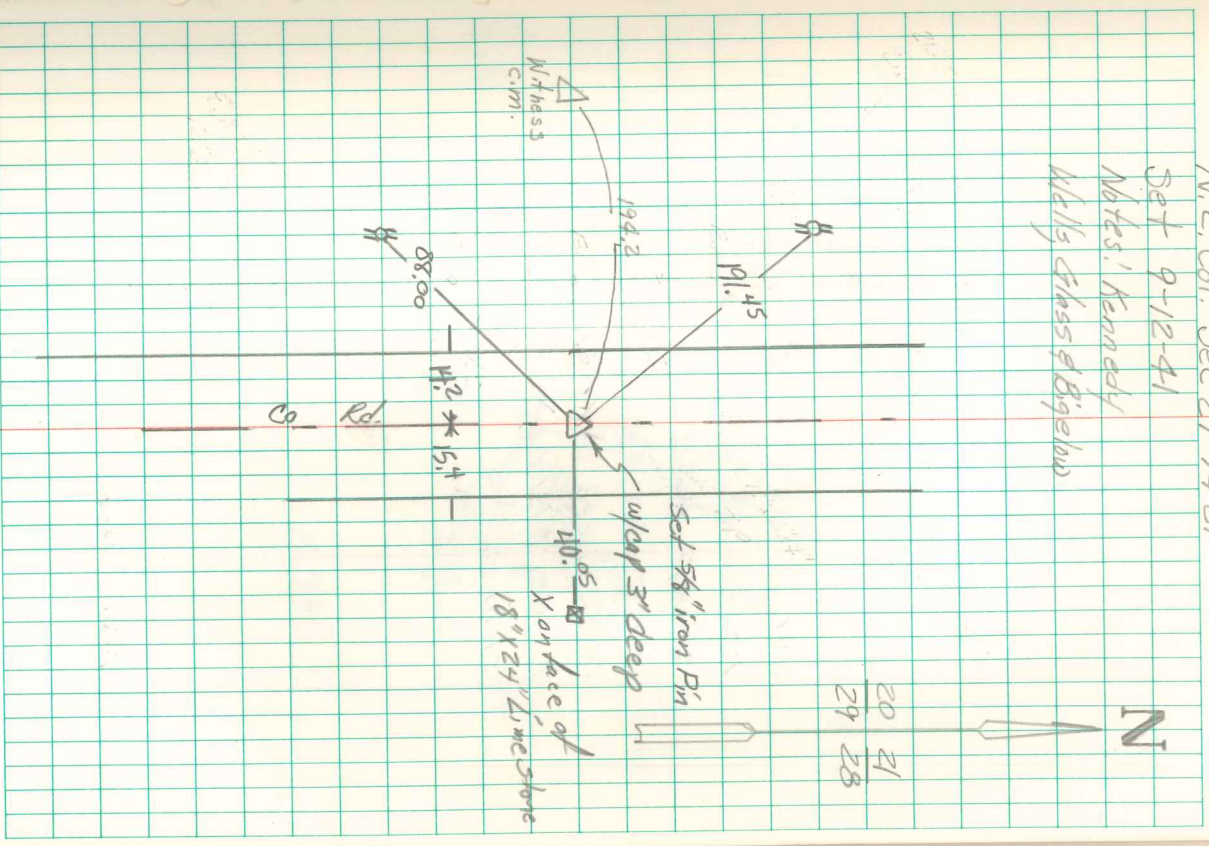

Found Crushed Lime Rock  
12" x 10" x 8" Right where we set C.M.

Set man over 1-OT to crushed  
Rock. Put Sandstone 22" x 8" x 5"  
on top C.M.

263.10 East of NW stone  
1319.0 " " 1/6 Cor stone  
2655.3 North of E 1/4 Cor Sec 29

194.2 East of witness man.

Orig. corner was destroyed in construction.  
Reestablished by projecting line  
from E<sup>4</sup> corner thru the NE<sup>4</sup> or SE<sup>4</sup> SS<sup>4</sup>  
at proportionment of previously measured  
distance. 11/19/99 Abie Davis