

Set - Conc. mon.

5.0' East of stream bed of Walnut Creek  
41.0' S.W. of 22" Walnut tree  
37.0' West of 10" White oak Cor Post  
to Fences E. & South

N  $\frac{1}{4}$  Cor sec 28-75-18

15

Set - 7-18-39

Notes: D. L. Thomas

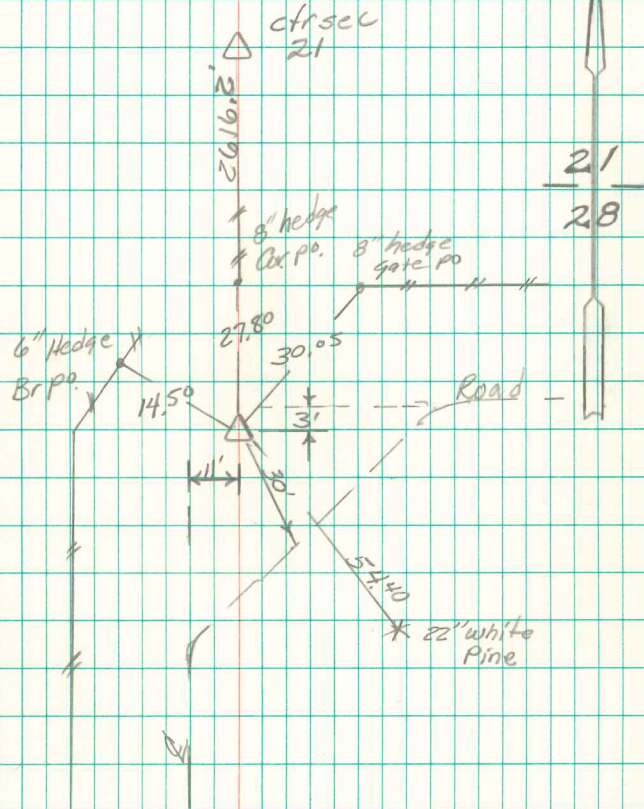

Found 1" pipe w/ cap #6708  
over CM. CM 10" deep  
11/11/99 Able Davis