

N 1/2 Con. 89-75-18

Set: 7-14-89

Notes: Wignall

Fid. Con. Nail in paving  
7.05' west of E

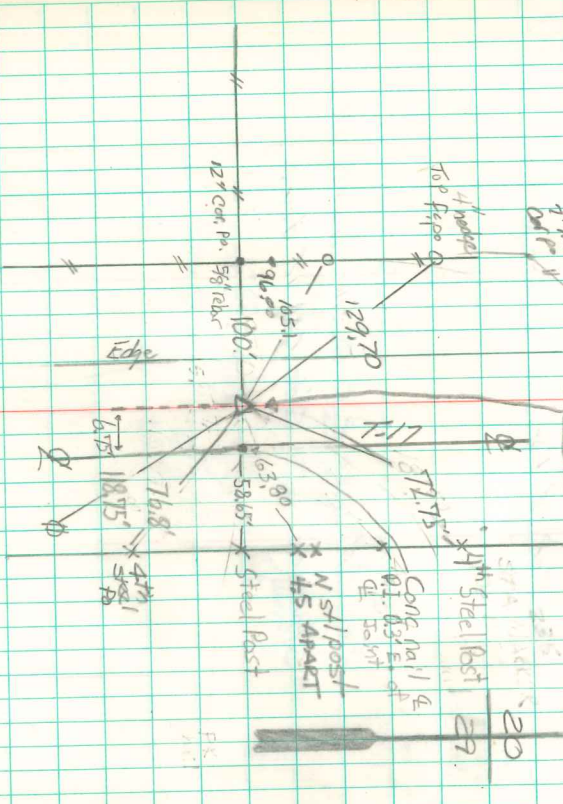

Set Iron Pin  
where C.M. was  
Removed by Construction

Revised 8-2-87

7/21/78  
9/24/01 Found Nail  
9/11/04  
4/9/05 M. De Pauw

Found yellow sandstone 8" x 8" x 8"  
and 2-2"  $\varnothing$  tile

Set C.M. over 2-2"  $\varnothing$  tile Horiz.  
N. E.S. Stones on N. Side.  
Placed rod 0.35 West and 0.10 South  
of C.M. Monument broken in transit.