

Found 3 stones scattered torn
out by Maintainer, 1-2" x 4" x 8" brick
over 8-8" tile. Tile at edge of
New Garden ditch.

Set CM over broken tile and
cockery 1-3" tile vertical on
N, S, 3 Stones and brick on SS. C.M.

N 1/4 Cor. 7-75-18
Set 10-6-39
Notes: Wignall

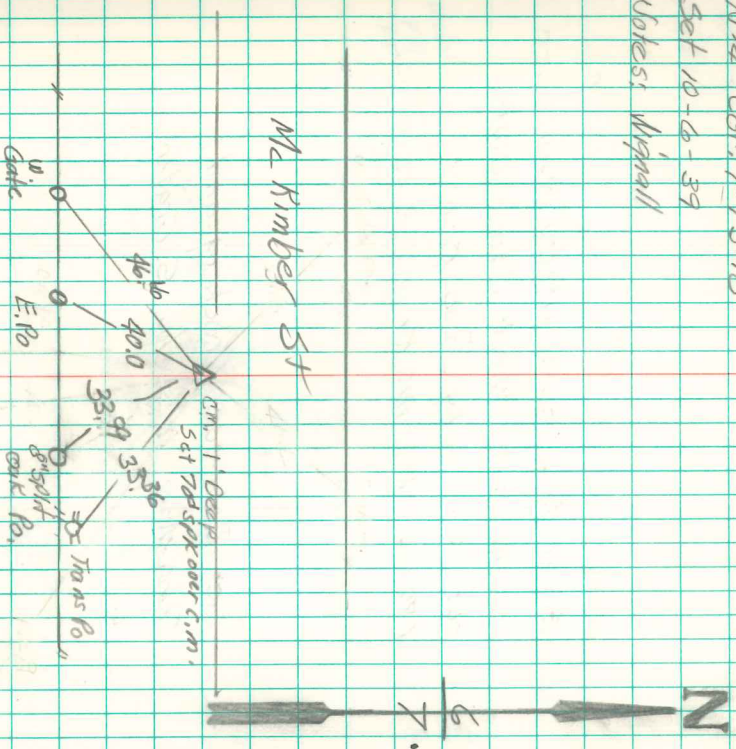

Found + Ret'd

4-14-79

By R.R. Wignall R.d.S.

5-14-01

By Robert Buss