

601960



Document 22-3682

Book 2022 Page 3682 Type CORNR Pages 1
Date 7/08/2022 Time 10:32 AM
Rec Amt \$7.00



GARDEN & ASSOC.

P.O. Box 451, Oskaloosa, Iowa 52577-0451 Phone: (641)672-2526

NAOMI ELLIS, RECORDER
MARION COUNTY IOWA

UNITED STATES PUBLIC LAND SURVEY CORNER CERTIFICATE

OF

Land Survey Monuments situated in Section 13, Township 75, Range 19, of the Fifth Principal Meridian, MARION County, Iowa. Previously recorded in N/A in County Recorder's Office.

Monument Description and Remarks: SEE BELOW

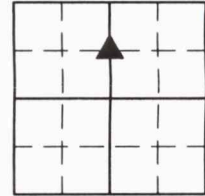

NE COR. SE-NW

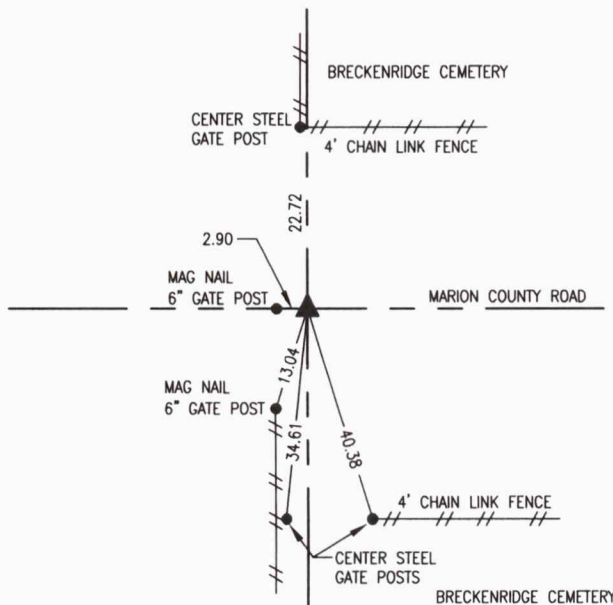

JUNE 28, 2022:
FOUND 1/2" REBAR 0.5' DEEP

I hereby certify that this land surveying document was prepared and the related survey work was performed by me or under my direct personal supervision and that I am a duly licensed Professional Land Surveyor under the laws of the State of Iowa.

Gary Wayne Keith 5 July 2022
Gary Wayne Keith, P.L.S. Date

License number: 11420
My license renewal date is December 31, 2022

SEAL



List Corners to be Indexed			
Corners	Section	Township	Range
NE COR. SE-NW	13	75	19

Pd \$7.00 Ck - Ret G&A Env.