



Document 21-6419

Book 2021 Page 6419 Type CORNR Pages 1
Date 10/07/2021 Time 1:03 PM
Rec Amt \$7.00

KAREN SCHWANEBECK, RECORDER
MARION COUNTY IOWA

Prepared by Mark L. Lee, PE, PLS, LEE Chamberlin Consultant Engineers, 3117 115th Street, Van Meter, Iowa 50261 Phone: 515-669-418

UNITED STATES PUBLIC LAND SURVEY CORNER CERTIFICATE OF

Land Survey Monuments situated in Section 13, Township 75 North, Range 20 West, of the Fifth Principal Meridian, MARION County, Iowa.

Previously recorded in N/A in the County Recorder's Office.

Monument Description and Remarks: FOUND NO MONUMENT OR TIES.
SET AT A POINT ON LINE AND EQUIDISTANT BTW THE
NE CORNER AND THE N/4 COR SEC 13-75-20.

PLAN - VIEW

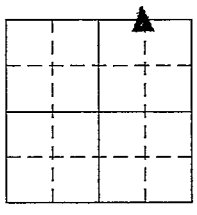
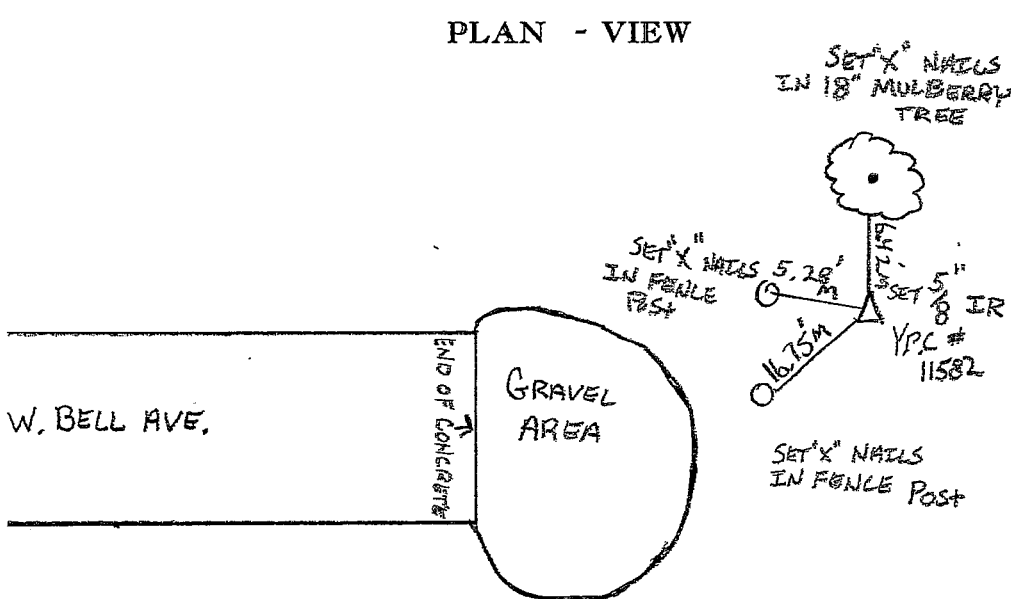

LEGEND

- ▲ FOUND SECTION CORNER MONUMENT
- FOUND MONUMENT
- I FOUND CHISELED "X" IN RIGHT-OF-WAY RAIL
- ⊗ FND "X" NAILS IN FENCE POST
- △ SECTION CORNER SET 5/8" I.P. W/YELLOW PLASTIC CAP *11582 (UNLESS NOTED)
- SET 5/8" I.P. W/YELLOW PLASTIC CAP *11582 (UNLESS NOTED)
- × SET "X" NAILS IN FENCE POST
- I.P. IRON PIPE
- I.R. IRON ROD (REROD)
- (M) MEASURED DIMENSION
- (P) or (R) PLATTED OR RECORDED DIMENSION
- SECTION LINE
- - - CENTERLINE
- × - × FENCE LINE
- 🌸 SET "X" NAILS IN TREE

NW COR NE 1/4 NE 1/4
SEC 13 - 75 - 20

I hereby certify that this land surveying document was prepared and the related survey work was performed by me or under my direct personal supervision and that I am a duly licensed Professional Land Surveyor under the laws of the State of Iowa.

Signature: Mark L. Lee
Mark L. Lee

Date: 10-5-2021 Reg. No. 11582
My license renewal date is Dec. 31, 2022.

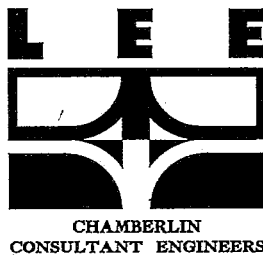
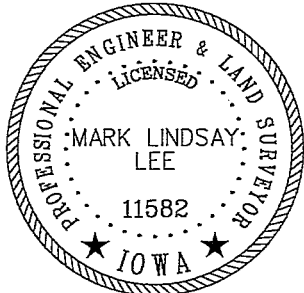

Corners	Section	Twp.	Range
NW COR NE 1/4 NE 1/4	13	75	20

21026

pd # 70 CHK. Ret. - MARK LEE