

INDEX LEGEND

COUNTY: MARION
SECTION: 27, T-75N, R-20W
CORNER: SW Corner

SURVEYOR & SURVEY COMPANY:
Jason S. Lowry, P.L.S.
Lowry Land Services, L.L.C.
752 Diamond Trail Rd., Searsboro, Iowa 50242

PREPARED BY AND RETURN TO:
Jason S. Lowry, P.L.S.
752 Diamond Trail Rd., Searsboro, Iowa 50242
(641) 521-1160, lowrylandservices@gmail.com

Instr. Number: 23-241
BK: 2023 PG: 241
Recorded: 1/19/2023 at 1:39:45.0 PM
County Recording Fee: \$7.00
Iowa E-Filing Fee: \$3.00
Combined Fee: \$10.00
Revenue Tax:
NAOMI ELLIS, RECORDER
Marion County, Iowa

UNITED STATES PUBLIC LAND SURVEY CORNER CERTIFICATE
Land Survey Monuments situated in Section 27, Township 75 North, Range 20 West of the Fifth Principal Meridian, Marion County, Iowa. Not previously recorded.

MONUMENT DESCRIPTION & REMARKS

SW Cor.— Found 4" x 4" WPA concrete monument using Marion County Engineer's ties.

No certificate of record.

This corner was used for a plat of survey in the W 1/2 of the SW 1/4 of Section 27.

PLAN VIEW

No Scale

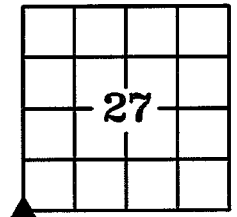

**SW Corner
Section 27**

Found 4" x 4" WPA concrete monument

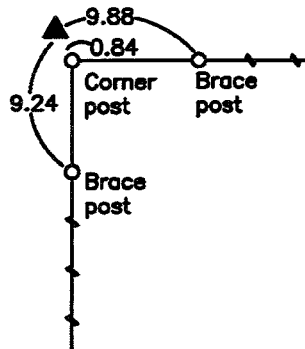

NOTE: ALL TIES ARE PLUMB MEASUREMENTS TO ORANGE SURVEY MARKER UNLESS NOTED.

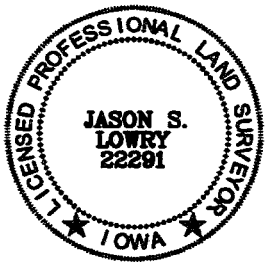

I hereby certify that this land surveying document was prepared and the related survey work was performed by me or under my direct personal supervision and that I am a duly Licensed Land Surveyor under the laws of the State of Iowa.

My license renewal date is 12/31/2023

Pages covered by this seal: 1 - 1

Jason S. Lowry
Jason S. Lowry
Iowa Lic. No. 22291

01/18/2023
Date

LEGEND

- ▲ Section Corner Found
- △ Section Corner Set
- Existing Fence

LAND CORNERS TO BE INDEXED

Land Corner	Section	Township	Range
SW Corner	27	75	20

LOWRY LAND SERVICES, L.L.C.

752 DIAMOND TRAIL RD., SEARSBORO, IOWA 50242, 641-521-1160

PROJ. NO. 0123

DATE OF SURVEY: 01/18/23

CERT NO. 1/3

Found 1-2" Round Tile.

Set C.M. over the Tile Lowered
in Place.

Put Granit Bolder 8"x6"x4" on Top C.M.

20.5' West of 28" Elm Tree

67.8' South West of 12" Burr oak Tree

50.5' North East of 6" Walnut "

68.7' " West " 10" Elm "

0.5' North of split oak Cor Post

N.E. Cor Sec 33-75-20

18

Set: April-24-1942

Notes: Kennedy - Wells, Mass.

