

NE CORNER SE 1/4 SW 1/4 SEC 4-75-20

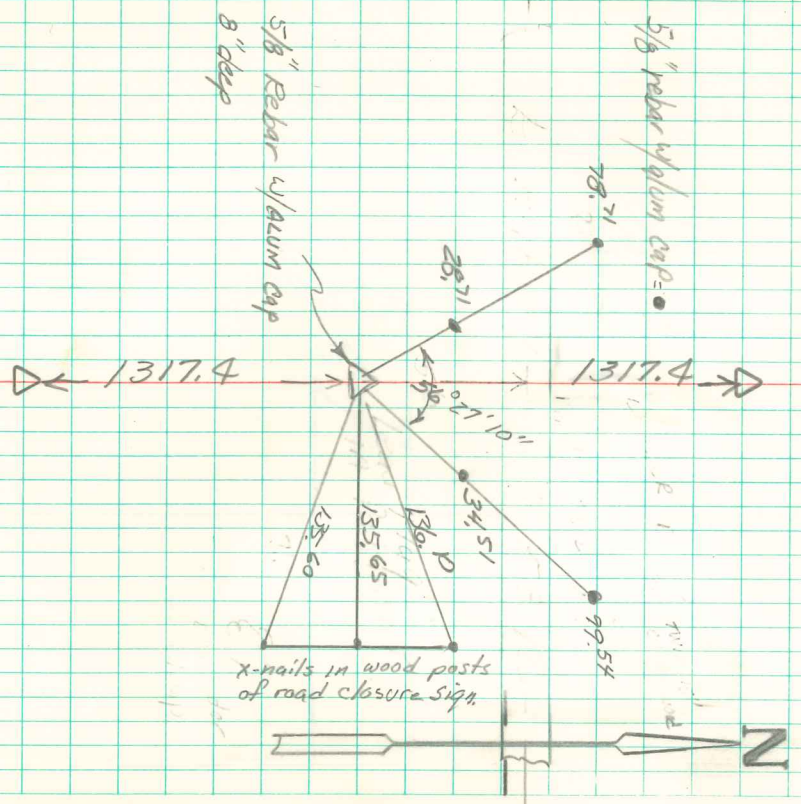

5/8" rebar w/ aluminum cap = ●

5/8" Rebar w/ aluminum cap
8" deep

x-nails in wood posts
of road closure sign

Pavement removed
Roadway resceded
Heath Martens # 9781
2/16/2005

Found carriage bolt & cut
1" in cone patch 5.00 South
of P from survey by Heutte
Dennis Kuntze IDOT 2/14/2005