



Document 22-816

Book 2022 Page 816 Type CORNR Pages 1
Date 2/11/2022 Time 1:18 PM
Rec Amt \$7.00

KAREN SCHWANEBECK, RECORDER
MARION COUNTY IOWA

Prepared By: J. Brian Morrissey, Morrissey Surveying & Consulting, LLC, 1405 Hwy. G28, Otley, Ia. 50214, 515-480-2531

UNITED STATES PUBLIC LAND SURVEY CORNER CERTIFICATE OF

Land Survey Monuments situated in Section 21, Township 76N, Range 18W, of the Fifth Principal Meridian, Marion County, Iowa.
Previously recorded in Bk. 2002, P. 1628 in the County Recorder's Office.

(book, page, document number, etc.)

(Show reason for preparing this certificate, the evidence and detailed procedures used in establishing the corner positions and monumentation found or placed.)

Monument Description and Remarks: Found 5/8" yellow plastic capped rebar, #6708, above W.P.A. Concrete Monument. Previous ties altered or obliterated and change in character of found monument.

This Corner was used for a Plat of Survey, Lot 1 of Parcel B, in the NW 1/4 of the NE 1/4 of Section 21.

PLAN VIEW

(Show a minimum of three reference ties to durable physical objects, relevant monuments and physical conditions that will enable recovery of the corner.)

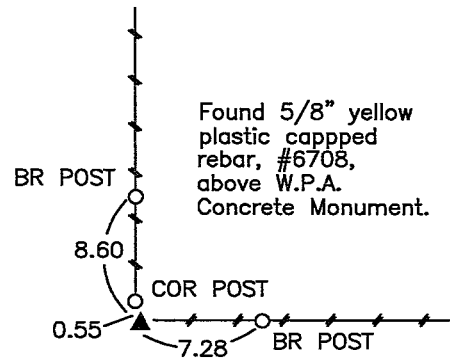
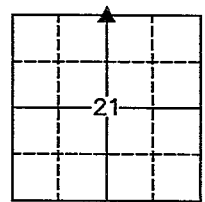

NW Cor., NW 1/4 of the NE 1/4, Section 21

Date of Survey: 11/19/21

NOTE: ALL TIES TO YELLOW/ORANGE PLASTIC SURVEY MARKER UNLESS NOTED.



I hereby certify that this land surveying document was prepared and the related survey work was performed by me or under my direct personal supervision and that I am a duly Licensed Land Surveyor under the laws of the state of Iowa.

Signature: J. Brian Morrissey Date: 2/10/22
J. Brian Morrissey

License number 7995.
My license renewal date is December 31, 2023

1140-21-2/4

PL#2022-0816-Ret Morrissey Surveying LLC

11

Found Rock 15"x13"x6" &
Crockery

Set c.m. on Crockery &
Stone on North side c.m.

N¹/₄ Cor sec 21-76-18

68

Set: -

Notes: Kennedy - Elsberry

