

Found limestone 24" x 18" x 6"
1-3" 4 tile

set CM.

Relied by Johnson & Vinson
Jan 11, 1947

N 1/4 Cor 13-76-19

Set: 11-2-39

Note: Wignall

Reset & Relied June 17, 1968

Moll Good 2-20-70

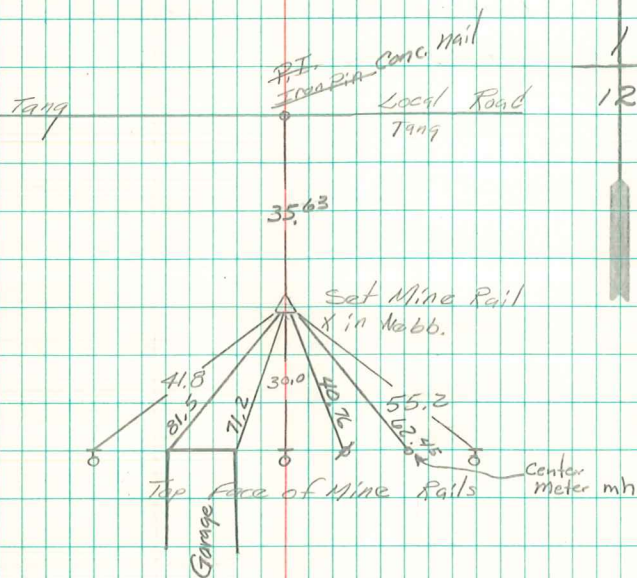

set 5/8" x 30" rebar from ties to top face of mine rails

set by Marion County prior to road construction.

March 8, 1993

Carsten Eng.