

INDEX LEGEND

COUNTY: MARION
SECTION: 10, T-76N, R-20W
CORNER: NW of the NE 1/4 of the SE 1/4

SURVEYOR & SURVEY COMPANY:
Jason S. Lowry, P.L.S.
Lowry Land Services, L.L.C.
752 Diamond Trail Rd., Searsboro, Iowa 50242

PREPARED BY AND RETURN TO:
Jason S. Lowry, P.L.S.
752 Diamond Trail Rd., Searsboro, Iowa 50242
(641) 521-1160, lowrylandservices@gmail.com

Instr. Number: 22-5363
BK: 2022 PG: 5363
Recorded: 10/12/2022 at 10:27:11.0 AM
County Recording Fee: \$7.00
Iowa E-Filing Fee: \$3.00
Combined Fee: \$10.00
Revenue Tax:
NAOMI ELLIS, RECORDER
Marion County, Iowa

UNITED STATES PUBLIC LAND SURVEY CORNER CERTIFICATE
Land Survey Monument situated in Section 10, Township 76 North, Range 20 West of the Fifth Principal Meridian, Marion County, Iowa. Not previously recorded.

MONUMENT DESCRIPTION & REMARKS

NW Cor. of the NE 1/4 SE 1/4 - No record of corner being set. Searched area and found nothing. Set 5/8" pink plastic capped rebar, P.L.S. #22291, on line and at a proportioned distance between E 1/4 & W 1/4. Said line was used previously for surveys in this section and position fit long standing fenceline south.

No certificate of record. This corner was used for a plat of survey in the NE 1/4 of the SE 1/4 of Section 10.

PLAN VIEW

No Scale

NW Corner
of the NW 1/4
of the SE 1/4
Section 10

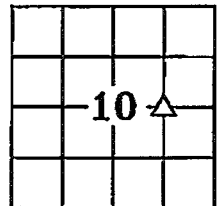

Set 5/8" x 18" pink plastic capped rebar, P.L.S. #22291.

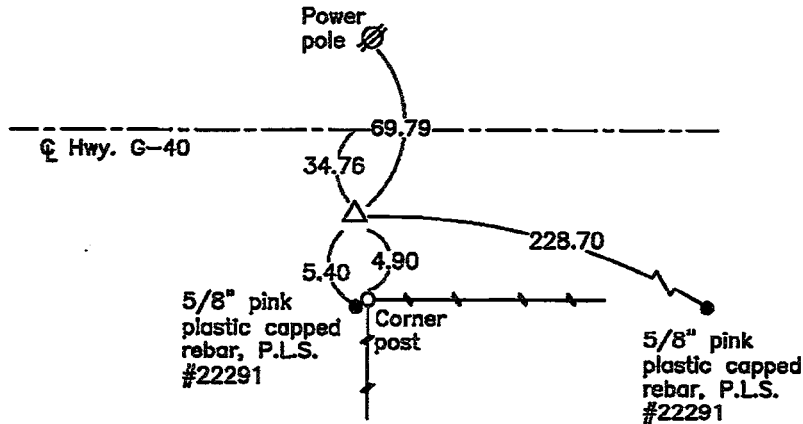

NOTE: ALL TIES ARE PLUMB MEASUREMENTS TO ORANGE SURVEY MARKER UNLESS NOTED.



I hereby certify that this land surveying document was prepared and the related survey work was performed by me or under my direct personal supervision and that I am a duly Licensed Land Surveyor under the laws of the State of Iowa.

My license renewal date is 12/31/2023

Pages covered by this seal: 1 - 1

Jason S. Lowry
Jason S. Lowry

Iowa Lic. No. 22291

10/12/22
Date

LEGEND

- ▲ Section Corner Found
- △ Section Corner Set
- Existing Fence

LAND CORNER TO BE INDEXED

| Land Corner | Section | Township | Range |
|------------------------------|---------|----------|-------|
| NW Cor. of the NE 1/4 SE 1/4 | 10 | 76 | 20 |

LOWRY LAND SERVICES, L.L.C.

752 DIAMOND TRAIL RD., SEARSBORO, IOWA 50242, 641-521-1160

PROJ. NO. 8422

DATE OF SURVEY: 10/07/22

CERT NO. 2/3