



Document 22-4351

Book 2022 Page 4351 Type CORNR Pages 1
Date 8/11/2022 Time 9:45 AM
Rec Amt \$7.00

NAOMI ELLIS, RECORDER
MARION COUNTY IOWA

Prepared By: J. Brian Morrissey, Morrissey Surveying & Consulting, LLC, 1405 Hwy. G28, Otley, Ia. 50214, 515-480-2531

UNITED STATES PUBLIC LAND SURVEY CORNER CERTIFICATE OF

Land Survey Monuments situated in Section 18, Township 76N, Range 19W, of the Fifth Principal Meridian, Marion County, Iowa.
Previously recorded in N.A. in the County Recorder's Office.

(book, page, document number, etc.)

(Show reason for preparing this certificate, the evidence and detailed procedures used in establishing the corner positions and monumentation found or placed.)

Monument Description and Remarks: Set 5/8" x 18" orange plastic capped rebar, P.L.S. #7995 at position based on Final Plat for Red Rock Heights Subdivision, Bk. 91, P. 349, and WPA 11/8/39 survey notes found in the County Engineer's Office. Land owner suggested that the original WPA monument may be several feet deep after road vacation and low area was filled in.

This Corner was used for a Plat of Survey in the SW 1/4 of the SW 1/4, Sec. 18

PLAN VIEW

(Show a minimum of three reference ties to durable physical objects, relevant monuments and physical conditions that will enable recovery of the corner.)

IOWA STATE PLANE COORDINATES
NAD83, SOUTH ZONE

NORTHING: 505062.59
EASTING: 1750158.95

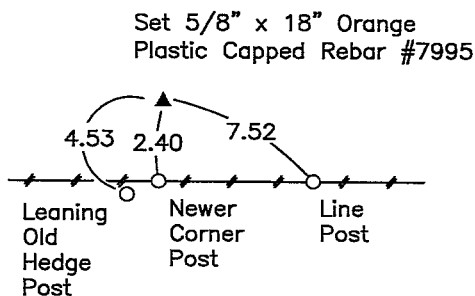
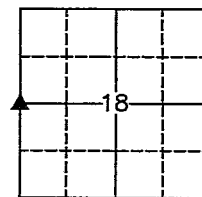

NW Cor., of the SW 1/4, Section 18

Date of Survey: 7/16/22

NOTE: ALL TIES TO BRASS DISK OR YELLOW/ORANGE SURVEY MARKER UNLESS NOTED.

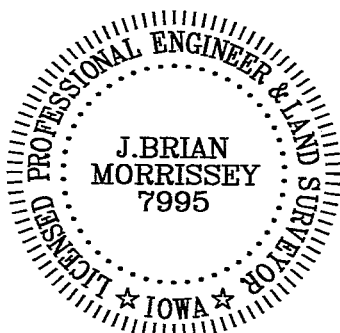

I hereby certify that this land surveying document was prepared and the related survey work was performed by me or under my direct personal supervision and that I am a duly Licensed Land Surveyor under the laws of the state of Iowa.

Signature: J. Brian Morrissey Date: 8/10/22
J. Brian Morrissey

License number 7995.

My license renewal date is December 31, 2023

1163-22-2/2

Plat CK-Red Morrissey Surveying Pick up

Found Field Boulder 18" x 10" x 6"

set c.m. Placed boulder on
West side.

E 1/4 Cor. Sec 13-76-20

set - 11-B-39

Notes: Wignall, Koons, Russell,
Durham & Mitchell

