

Found Granite Rock 24"x18"x12"
2-2" Horse Shoe Tile one Tile only
6" Long

Lowered 2-2" Tile Laying Parallel
N.E.S. and set Concrete Monument
on Top of Tile,
Placed Granite Rock on East side
of C.M.

N¹/₄ Cor Sec 13-76-20

Set 12-22-39

Notes: Kennedy - Wignall, Frazier
& Hewitt.

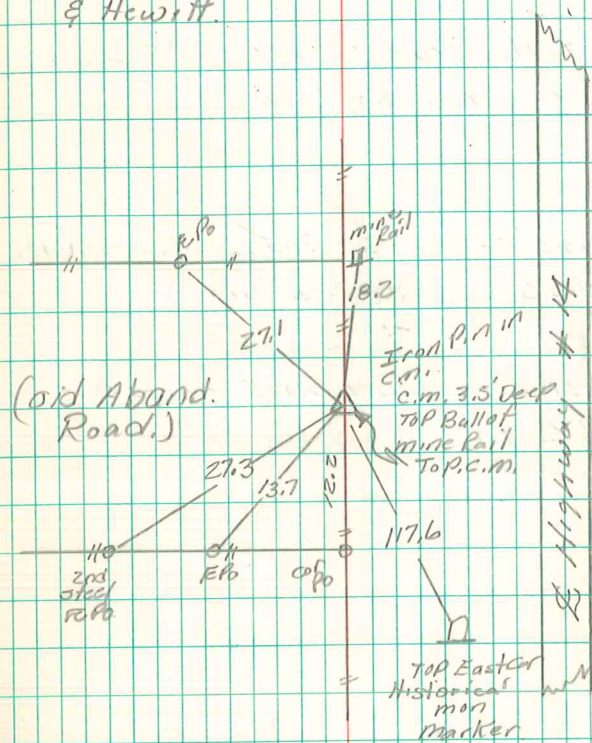

Retied May 19-1970

Feind 12/18/90