

INDEX LEGEND

COUNTY: MARION  
SECTION: 22, T-76N, R-20W  
CORNER: SW COR., SE 1/4, NW 1/4.

SURVEYOR & SURVEY COMPANY:  
Jason S. Lowry, P.L.S.  
Lowry Land Services, L.L.C.  
752 Diamond Trail Rd., Searsboro, Iowa 50242

PREPARED BY AND RETURN TO:  
Jason S. Lowry, P.L.S.  
752 Diamond Trail Rd., Searsboro, Iowa 50242  
(641) 521-1160, lowrylandservices@gmail.com

Instr. Number: 22-1487  
BK: 2022 PG: 1487  
Recorded: 3/18/2022 at 2:55:20.0 PM  
County Recording Fee: \$7.00  
Iowa E-Filing Fee: \$3.00  
Combined Fee: \$10.00  
Revenue Tax:  
KAREN SCHWANEBECK, RECORDER  
Marion County, Iowa

**UNITED STATES PUBLIC LAND SURVEY CORNER CERTIFICATE**

Land Survey Monuments situated in Section 22, Township 76 North, Range 20 West of the Fifth Principal Meridian, Marion County, Iowa. Not previously recorded.

**MONUMENT DESCRIPTION & REMARKS**

SW Cor., NW 1/4, SE 1/4-- No record of corner being set. Searched area and found nothing. Set 5/8" x 18" pink plastic capped rebar, P.L.S. #22291, on line between NE Cor., NW 1/4 of the NW 1/4 & SE Cor., SW 1/4 of the SW 1/4 and at the intersection of a long standing fence line west.

No certificate of record. This corner was used for a plat of survey in the SE 1/4 of the NW 1/4 of Section 22.

PLAN VIEW

No Scale

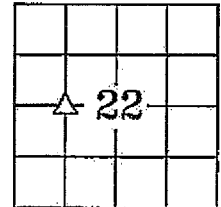

SW Corner

SE 1/4 of the NW 1/4

Section 22

Set 5/8" x 18" pink plastic capped rebar, P.L.S. #22291

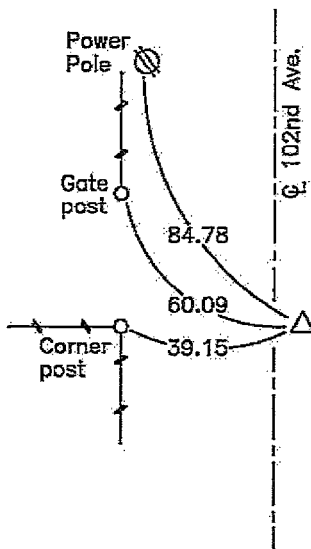

NOTE: ALL TIES ARE PLUMB MEASUREMENTS TO ORANGE SURVEY MARKER UNLESS NOTED.

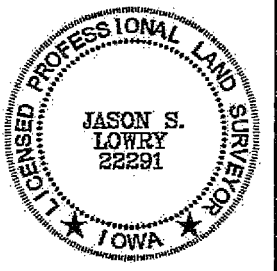

I hereby certify that this land surveying document was prepared and the related survey work was performed by me or under my direct personal supervision and that I am a duly Licensed Land Surveyor under the laws of the State of Iowa.

My license renewal date is 12/31/2023

Pages covered by this seal: 1 - 1

LEGEND

- ▲ Section Corner Found
- △ Section Corner Set
- ↔ Existing Fence

LAND CORNERS TO BE INDEXED

Land Corner	Section	Township	Range
SW Corner SE 1/4, NW 1/4	22	76	20

*Jason S. Lowry*  
Jason S. Lowry Iowa Lic. No. 22291 Date 3/18/22

LOWRY LAND SERVICES, L.L.C. 752 DIAMOND TRAIL RD., SEARSBORO, IOWA 50242, 641-521-1160

PROJ. NO. 1922 DATE OF SURVEY: 03/16/22 CERT NO. 3/4