

Found Lime Rock 8"x6"x4" over
2-2" D Tile

Set C.M. over 1-2" D Tile Lowered
in Place

Stone TOP C.M.

N $\frac{1}{4}$ cor 30-76-20

Set - 10-15-40

Notes: Kennedy

Party = Wells, Burrus, Crozier & Hewitt

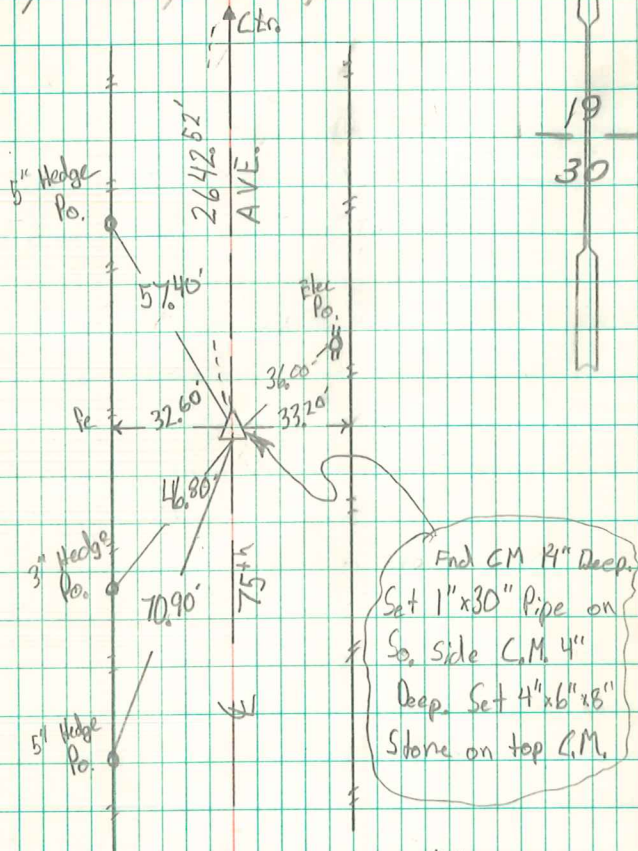

8/11

Able Davis