

Found Granit Rock 12"x10"x10"  
over 2-2" Horse shoe tile

set c.m. over one of the tile  
Lowered in Place,

Put the Rock on Top c.m.

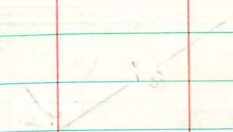

Ely Cor Sec 12-76-21

Set 5-24-41

Notes: Kennedy, Wells, Frazier &  
Elsberry.

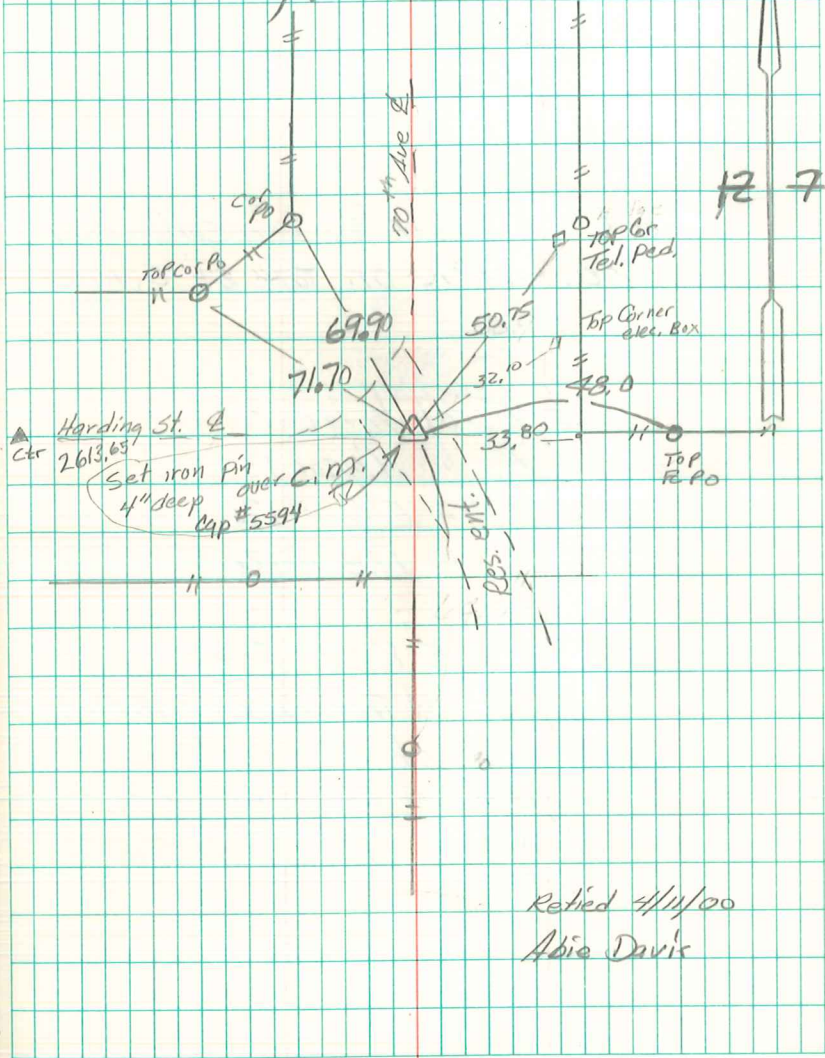

Retied 4/11/00  
Abie Davis