



Document 17-5218

Book 2017 Page 5218 Type CORNR Pages 1
Date 11/29/2017 Time 10:30 AM
Rec Amt \$7.00

KAREN SCHWANEBECK, RECORDER
MARION COUNTY IOWA

Prepared by Abie C. Davis, P.E. & L.S., 1428 Oregon St., Knoxville, IA 50138 (641) 842-5863

UNITED STATES PUBLIC LAND SURVEY CORNER CERTIFICATE OF

Land survey Monuments situated in Section 18, Township 76 N, Range 21 W of the Fifth Principal Meridian, Marion County, Iowa.

Previously recorded in N/A in County Recorders Office.

Show reason for preparing this certificate, the evidence and detailed procedures used in establishing the corner positions and monumentation found or placed

Monument Description and Remarks: set corner in line with property line fence north and property line fence east and at 1328.1' distance from SW Corner of the NE+SE4

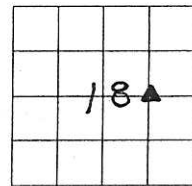

PLAN - VIEW

(Show a minimum of three reference ties to durable physical objects, relevant monuments and physical conditions that will enable recovery of the corner.)

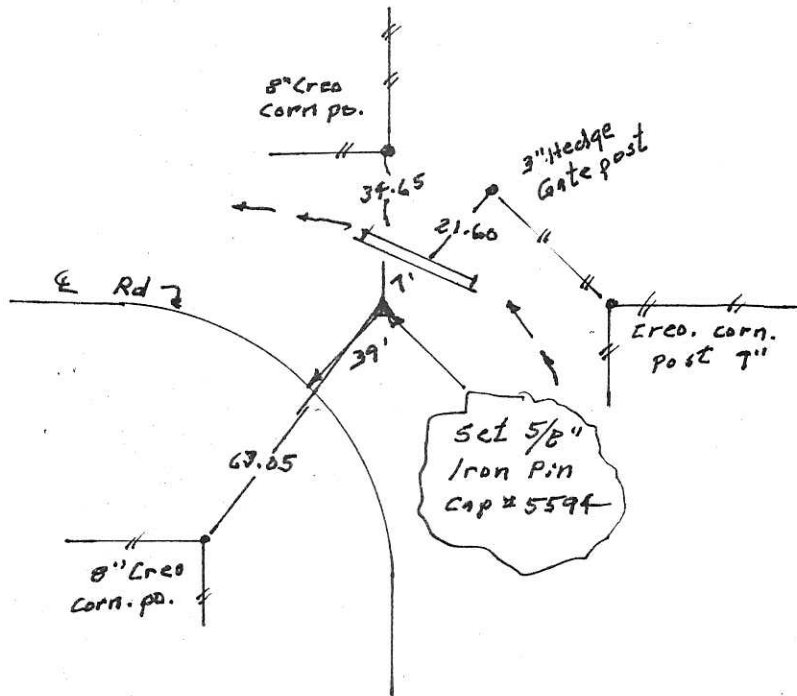

I hereby certify that the survey work was completed and this land surveying document was prepared by me or under my direct personal supervision and that I am a duly licensed land surveyor under the laws of the state of Iowa

Signature: Abie C. Davis
Abie C. Davis, P.E. & L.S.

Date: 11/27/17 Reg. No. 5594

My license renewal date is December 31, 2017

SEAL

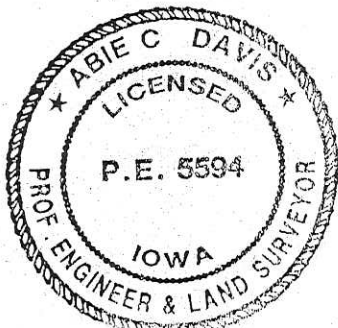

List Corners to be Indexed			
Corners	Section	Twp	Range
NW Corn.	18	76 N	21 W
NE+SE4			

Pd \$700 Cash - Ret Abie Davis