

Found sand stone 16" x 8" x 4"
over 1-3" Drain Tile

set c.m. over 1-3" Drain Tile Lowered
in Place.

Put stone TOP C.M.

C.M. 12" below TOP surface

N.W. Cor 19-76-21

Set - 10-10-40

Notes: Kennedy

Party Wells, Burgess, Crozier & Hewitt

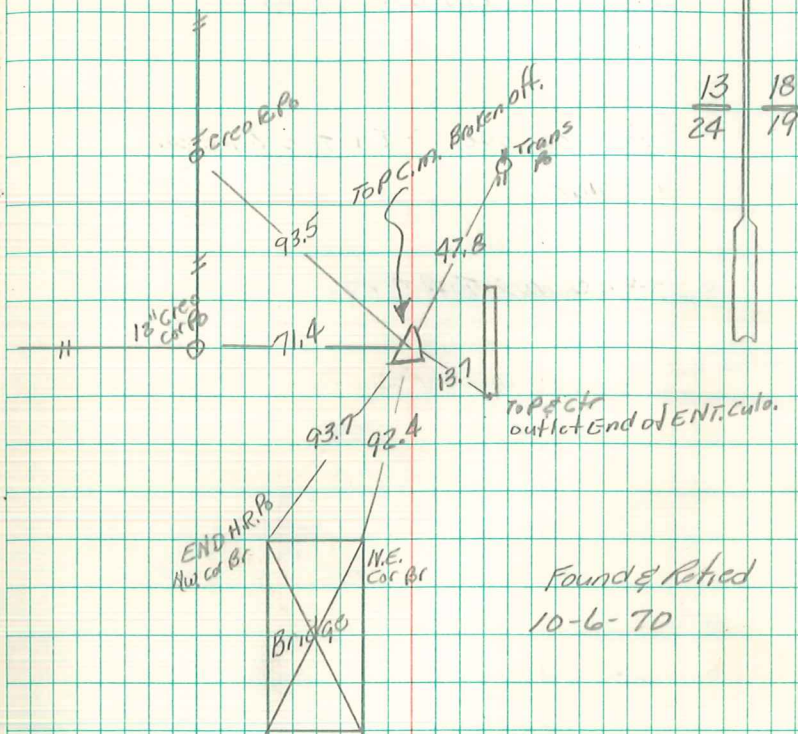

Found & Retied
10-6-70