

INDEX LEGEND

COUNTY: MARION
SECTION: 18, T-76N, R-21W
CORNER: S 1/4 Corner

SURVEYOR & SURVEY COMPANY:
Jason S. Lowry, P.L.S.
Lowry Land Services, L.L.C.
752 Diamond Trail Rd., Searsboro, Iowa 50242

PREPARED BY AND RETURN TO:
Jason S. Lowry, P.L.S.
752 Diamond Trail Rd., Searsboro, Iowa 50242
(641) 521-1160, lowrylandservices@gmail.com

Instr. Number: 23-38
BK: 2023 PG: 38
Recorded: 1/4/2023 at 9:58:30.0 AM
County Recording Fee: \$7.00
Iowa E-Filing Fee: \$3.00
Combined Fee: \$10.00
Revenue Tax:
NAOMI ELLIS, RECORDER
Marion County, Iowa

UNITED STATES PUBLIC LAND SURVEY CORNER CERTIFICATE
Land Survey Monuments situated in Section 18, Township 76 North, Range 21 West of the Fifth Principal Meridian, Marion County, Iowa. Not previously recorded.

MONUMENT DESCRIPTION & REMARKS

S 1/4 Corner— Marion County Engineer's ties call for stone over concrete monument. Searched and found 20" x 8" x 6" pointed brown sandstone over concrete monument. Accepted stone and set 5/8" x 18" pink plastic capped rebar, P.L.S. #22291, on north side of stone for locating purposes.

No certificate of record.

This corner was used for a plat of survey in the NW 1/4 of the SE 1/4 of Section 18.

PLAN VIEW

No Scale

**S 1/4 Corner
Section 18**

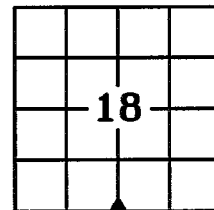

Found 20" x 8" x 6" pointed brown sandstone.

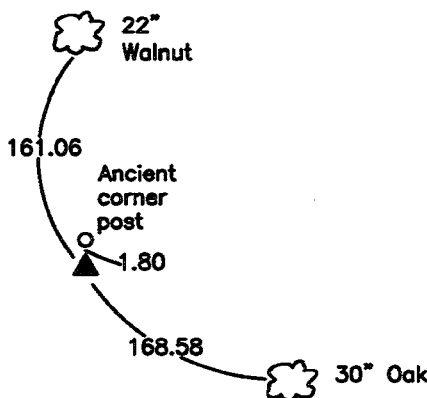

NOTE: ALL TIES ARE PLUMB MEASUREMENTS TO ORANGE SURVEY MARKER UNLESS NOTED.



I hereby certify that this land surveying document was prepared and the related survey work was performed by me or under my direct personal supervision and that I am a duly Licensed Land Surveyor under the laws of the State of Iowa.

My license renewal date is 12/31/2023

Pages covered by this seal: 1 - 1

Jason S. Lowry
Jason S. Lowry

1/4/23

Iowa Lic. No. 22291

Date

LEGEND

- ▲ Section Corner Found
- △ Section Corner Set
- Existing Fence

LAND CORNERS TO BE INDEXED

Land Corner	Section	Township	Range
S 1/4 Corner	18	76	21

LOWRY LAND SERVICES, L.L.C.

752 DIAMOND TRAIL RD., SEARSBORO, IOWA 50242, 641-521-1160

PROJ. NO. 7822

DATE OF SURVEY: 11/22/22

CERT NO. 1/3

Found sandstone 20"x8"x6" over
2-2" D Tile, right where we set
c.m.

Set c.m. over 1-2" D Tile Lowered
in Place.

Stone Top C.M.

C.M. 18" Below Top of Surface

N $\frac{1}{4}$ Cor 19-76-21

Set 10-10-40

Notes: Kennedy

Party - Wells, Burris, Crozier & Hewitt.

