

Found Piece of Cement
15" x 7" x 2" over 2-2" D Tile
Top Tile Broken

Lowered 1-2" Tile in orig upright
Pos. & set C.M. over it. Broken
Tile on N. side C.M.

Conc. Slab on Top C.M.

C.M. 12" under surface

E $\frac{1}{4}$ Cor. 1-76-21
set 5-27-41
Notes: Wignall

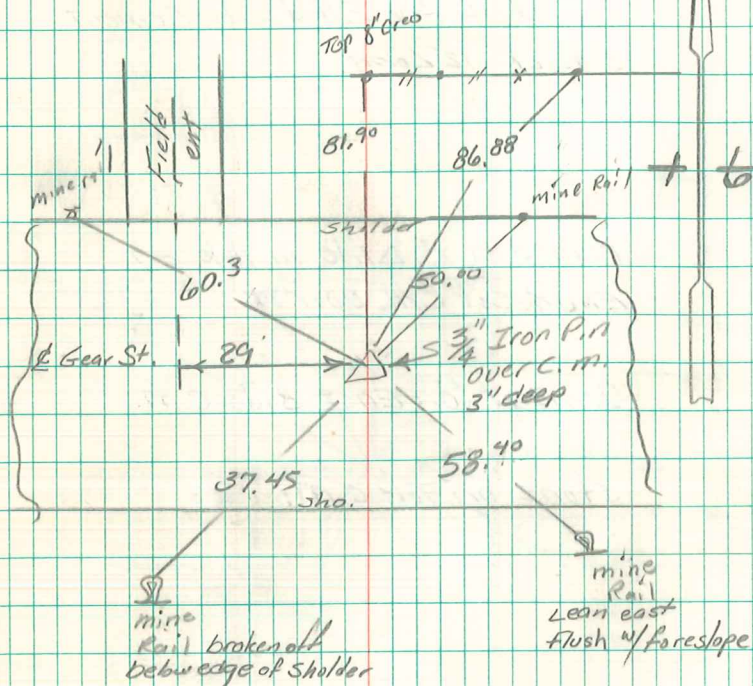

This Cor Stone Buried by Corps
Construction, ITEM #15. Reset by Corps
of Eng. & Retied Aug-6-1969 by
Co. Eng. office.

RETIED 24 APRIL 89
3/30/00