



GARDEN & ASSOC.

P.O. Box 451, Oskaloosa, Iowa 52577-0451 Phone: (641)672-2526

NAOMI ELLIS, RECORDER
MARION COUNTY IOWA

UNITED STATES PUBLIC LAND SURVEY CORNER CERTIFICATE

OF

Land Survey Monuments situated in Section 29, Township 76, Range 21, of the Fifth Principal Meridian, MARION County, Iowa. Previously recorded in NO CERTIFICATE OF RECORD in County Recorder's Office. Monument Description and Remarks: SEE BELOW

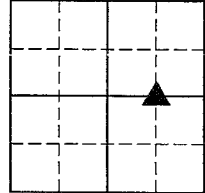

NW CORNER NE-SE

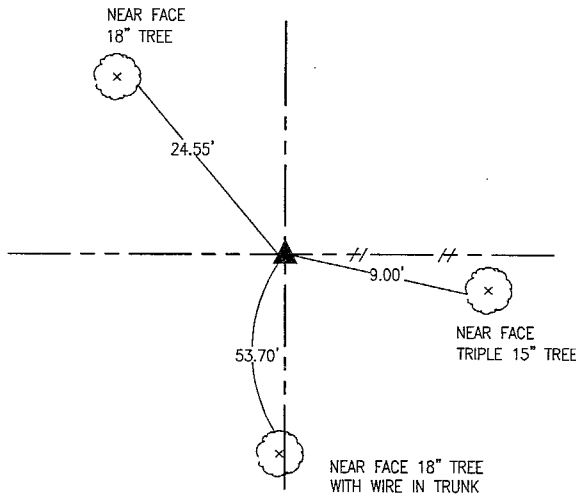

DECEMBER 2021

NO RECORDS FOR THE CORNER IN THE RECORDER OR ENGINEER'S OFFICE. FOUND PINK RIBBON ON EXISTING END POST. DUG HOLE 1 FOOT DEEP AROUND POST, PROBES, AND SEARCHED WITH METAL LOCATOR. DID NOT FIND MONUMENT. SET 5/8" X 30" REBAR WITH CAP #19960 AT FENCE END POST.

I hereby certify that this land surveying document was prepared and the related survey work was performed by me or under my direct personal supervision and that I am a duly licensed Professional Land Surveyor under the laws of the State of Iowa.

Bobby J. Maddaleno 5-16-22
Bobby J. Maddaleno, P.L.S. Date

License number: 19960

My license renewal date is December 31, 2021

SEAL

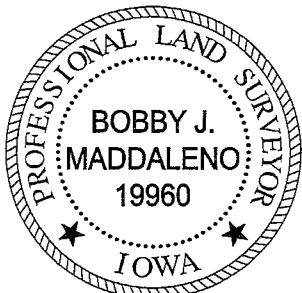

List Corners to be Indexed
Corners Section Township Range

NW COR NE-SE 29 76 21

Pd # 700 CK - Ret G&A Env.