

Found sandstone 11" x 9" x 1"  
Right where we set man.

stone on TOP C.M.

stone 3" Above TOP Ground

N.W. Cor 30-76-21  
set 11-15-40  
Notes: Kennedy  
Party - Shraw, Mitchell

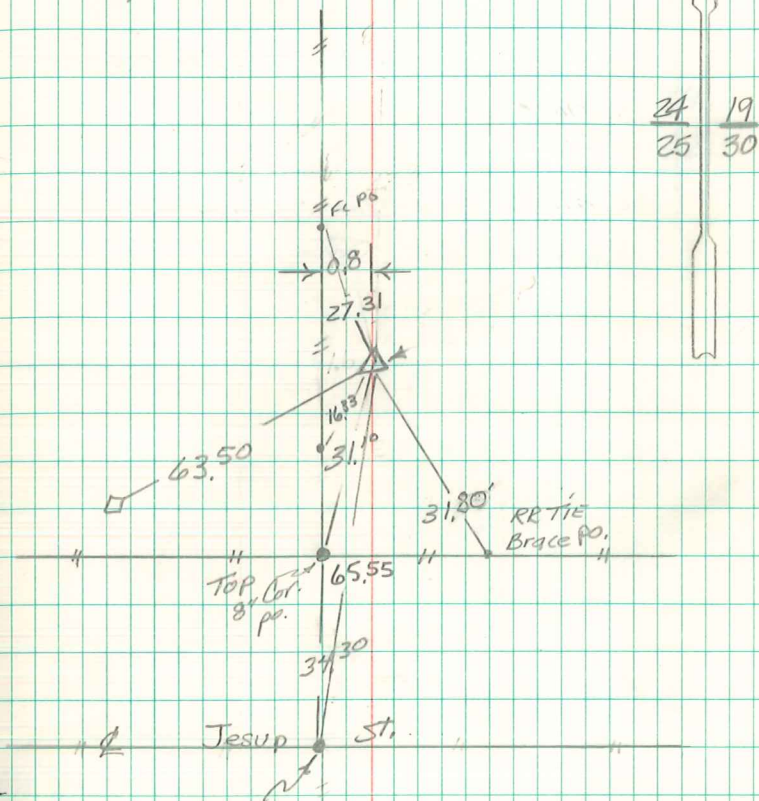

24	19
25	30

1/2" iron pin  
3" deep

And Conc. Man 9" deep  
w/ limestone on top set 5/8"  
iron pin on N. side CM  
flush w/ground 6/21/01

8-7-06  
Scott Steinfadt

# 5594 Abie Davis