

Found 2-stones 20"x8"x5" &
14"x10"x12" over 2-2" D tile on END.

Lowered 1-2" D tile in Place

set c.m. stones on N. side c.m.

N. E. Cor 35-76-21

Set 6-27-40

Notes: Wignall

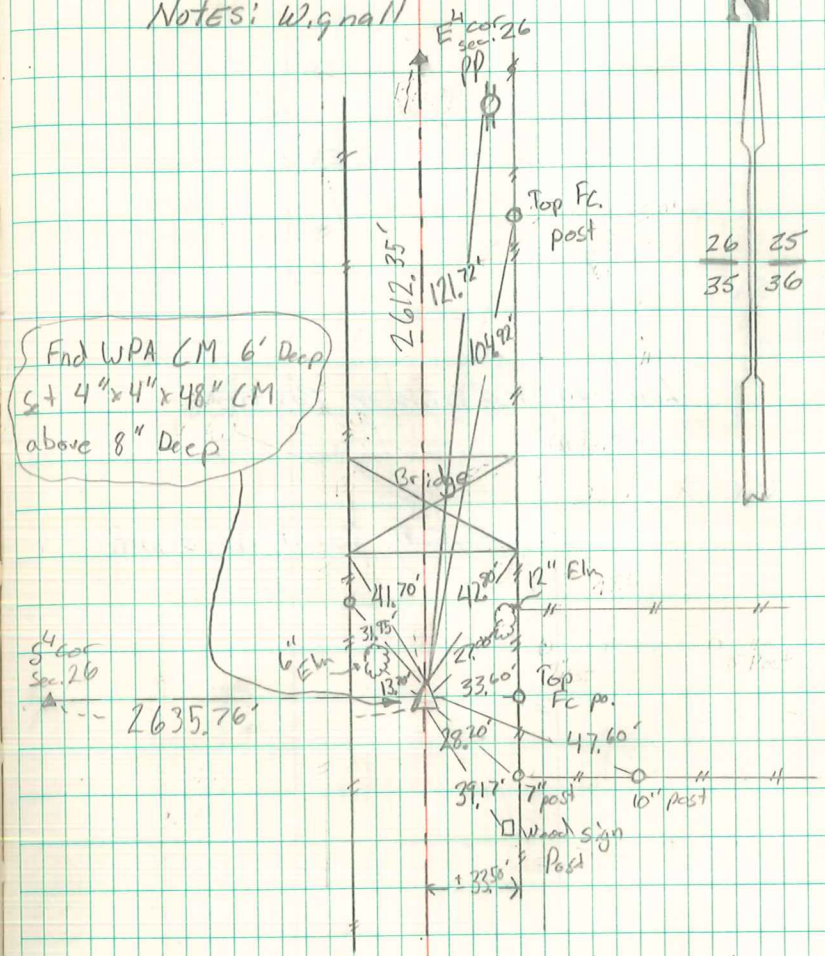

Find WPA CM 6' Deep
Set 4"x4"x48" CM
above 8" Deep

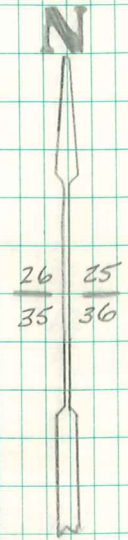

Retied 10/5/99
Mark Wignall 11465
4/4/2000 I.D.B.T.