

Found Lime Stone 8"x5"x4" at  
True corner - No Tile

10° N.W. Found 2-2" D Tile wit. Cor.

Lowered Lime stone & set C.M over  
it. 16" below surface.

N<sup>1</sup>/<sub>4</sub> Cor 4-76-21  
Set 7-8-40  
Notes: Wignall

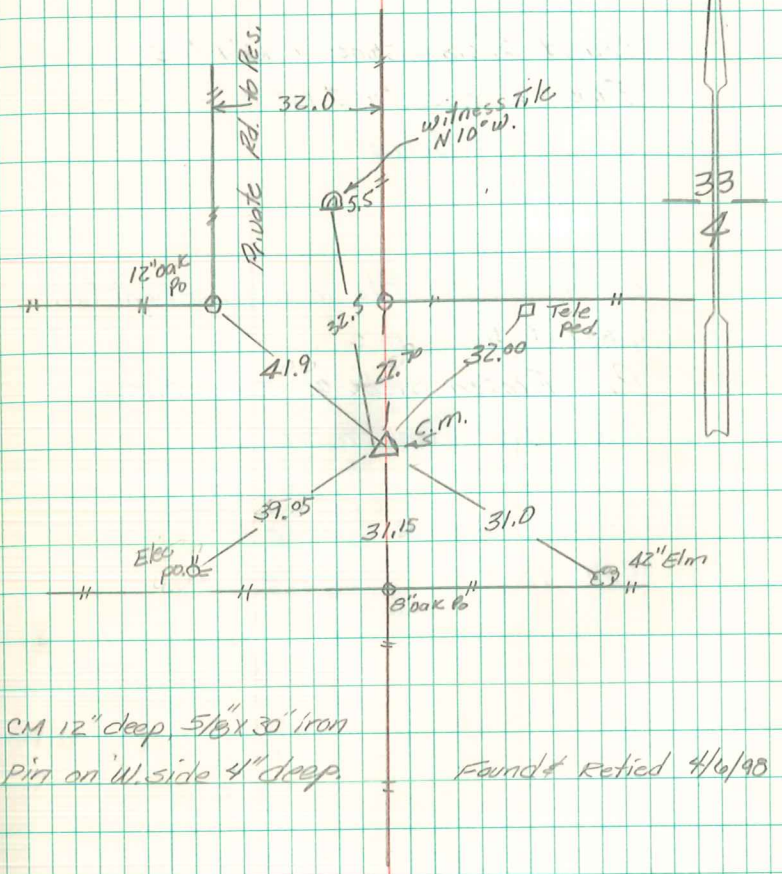

CM 12" deep 5/8" x 30" iron  
pin on W. side 4" deep

Found & Retied 4/6/98