

Found Granit Rock 12"x12"x8"
over 2-2" DTile, right where we
set c.m.

set c.m. over 1-2" DTile Lowered
in place.

stone on TOP c.m.

N.E. Cor 4-76-21

Set - 10-9-40

Notes - Kennedy

Party - Wells, burrus, Crozier & Hewitt

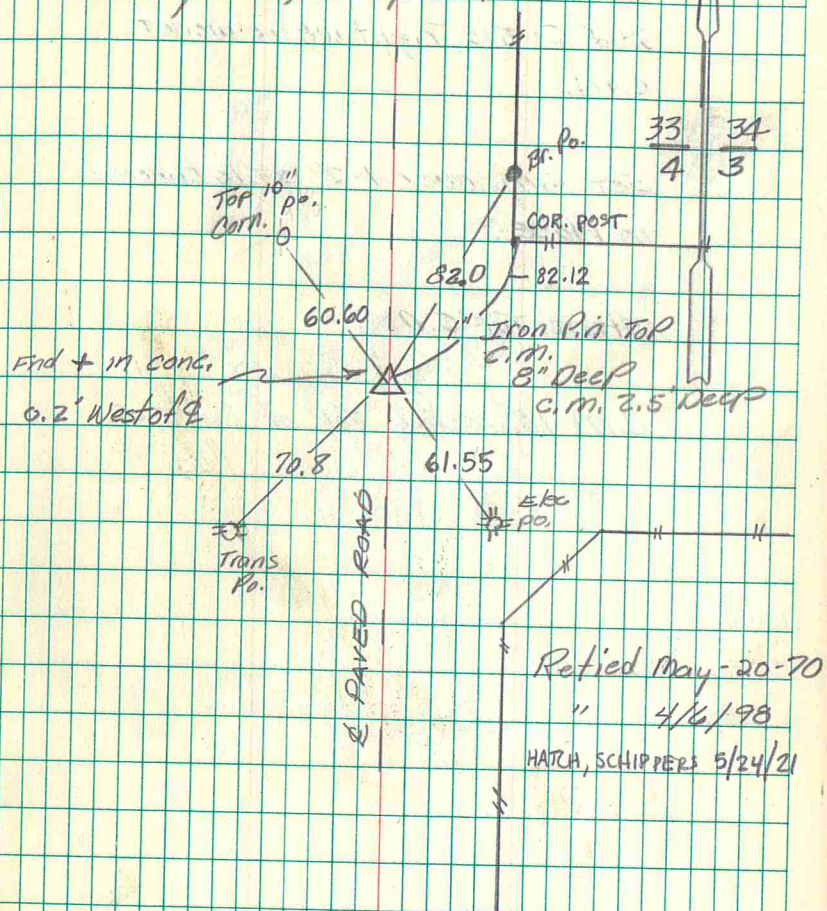

Found Granit Rock 12"x12"x8"
over 2-2" D Tile, right where we
set c.m.

set c.m. over 1-2" D Tile Lowered
in place.

stone on top c.m.

N.E. Cor 4-76-21

Set - 10-9-40

Notes - Kennedy

Party - Wells, burris, Crozier & Hewitt

