

Found yellow sandstone 24"x10"x4"
& 2-2" D Tile

Set c.m. over 1-D Tile & set stone
on North side c.m.

N.E. Cor. 6-76-21

Set 7-8-40

By Nandoll, Frazier, Harger

Shap. Notes by Wignall

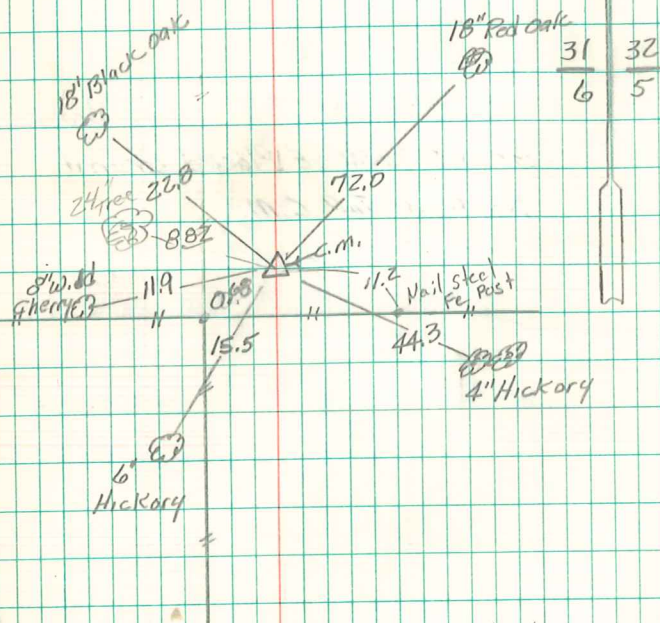

Retired 8/17/98

Mark Wandro