

5 1/2 Cr Sec. 17-77-18
△ Cr Sec 17-77-18

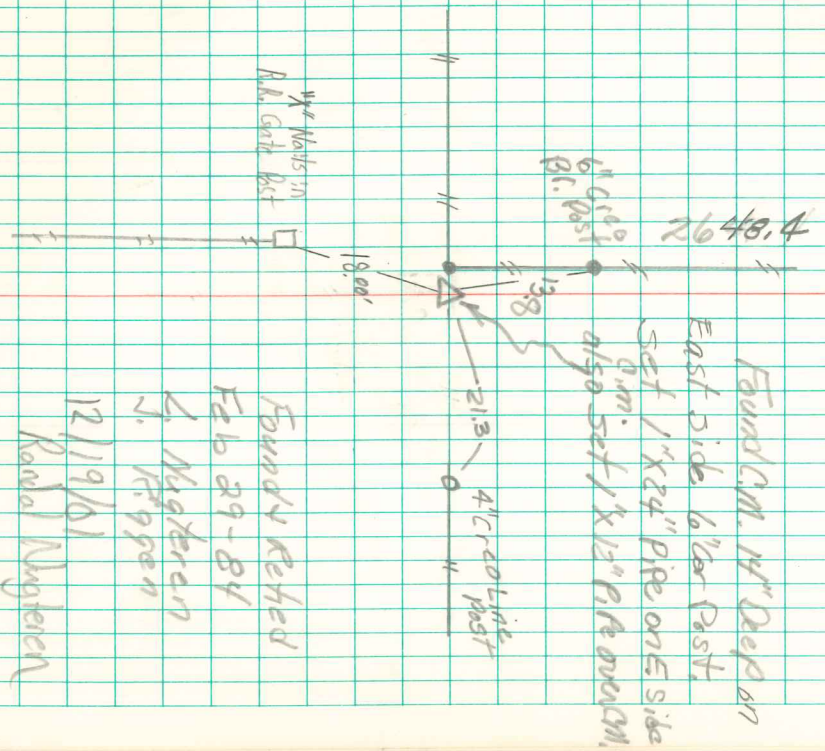

Foundy Rethed
Feb 29-84
J. Mygleren
12/19/01
Kamal Mygleren

Found CM. 14" Deep on
East Side 6" or Post.
Set 1" X 24" Pipe on E side
0.1 m.
also Set 1" X 13" Pipe on W side

1/4" Nails in
A.A. Gate Post