



Document 18-357

Book 2018 Page 357 Type CORNR Pages 1
Date 1/25/2018 Time 10:26 AM
Rec Amt \$7.00

KAREN SCHWANEBECK, RECORDER
MARION COUNTY IOWA

Prepared By: J. Brian Morrissey, Morrissey Surveying & Consulting, LLC, 1405 Hwy. G28, Otley, Ia. 50214, 515-480-2531

UNITED STATES PUBLIC LAND SURVEY CORNER CERTIFICATE OF

Land Survey Monuments situated in Section 25, Township 77N, Range 18W, of the Fifth Principal Meridian, Marion County, Iowa.
Previously recorded in n/a in the County Recorder's Office.
(book, page, document number, etc.)

(Show reason for preparing this certificate, the evidence and detailed procedures used in establishing the corner positions and monumentation found or placed.)

Monument Description and Remarks: Set 5/8" x 18" rebar with orange plastic cap P.L.S. 7995 at mathematical center of Quarter Section using found Section Corners and Quarter Quarter positions at midpoint and on line between found Quarter Corners.

This Corner was used for a Plat of Survey in the NE 1/4 of the SE 1/4 of Sec. 25, recorded in Bk. 2017, P. 1211.

PLAN VIEW

(Show a minimum of three reference ties to durable physical objects, relevant monuments and physical conditions that will enable recovery of the corner.)

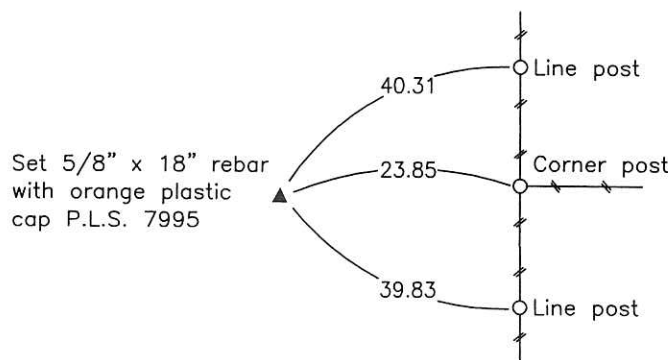
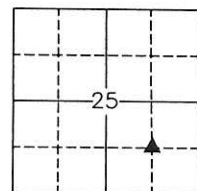

SW Corner, NE 1/4, SE 1/4 Section 25

Date of Survey: 3/18/17

NOTE: ALL TIES TO BRASS DISK OR YELLOW/ORANGE SURVEY MARKER UNLESS NOTED.

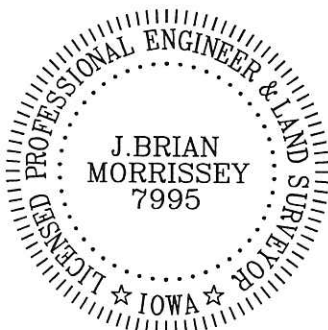

I hereby certify that this land surveying document was prepared and the related survey work was performed by me or under my direct personal supervision and that I am a duly Licensed Land Surveyor under the laws of the state of Iowa.

Signature: J. Brian Morrissey Date: 1/23/18
J. Brian Morrissey

License number 7995.

My license renewal date is December 31, 2019

908-17-2/2

RD \$700 ck - Ret Morrissey Surveying