

N⁴ Con. Sec. 29-77-18

N

End. WPA Conc. Mon. 15" Deep w/
8" x 8" x 20" Pyramidal Limestone on
N. side of Conc. Mon.

Top of stone is 6" above conc. mon.
Set 5/8" x 30" Rebar on E. & W. sides of CM.

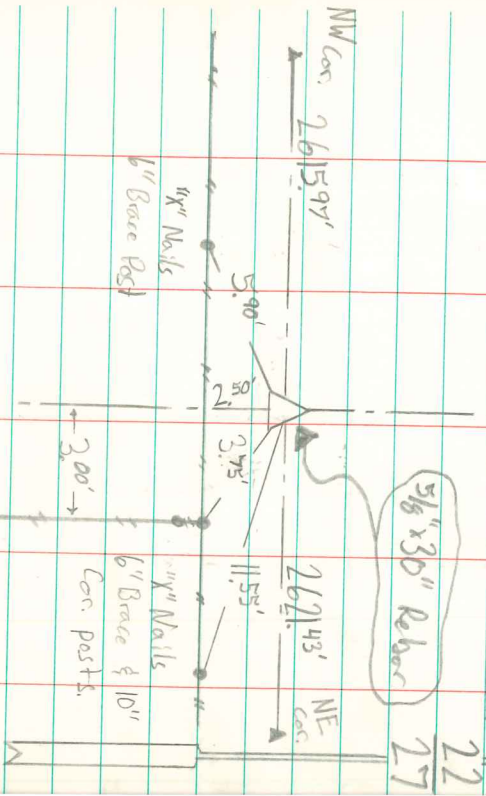

4/21/04
Kunda Dugteren