

Instr. Number: 22-2967
 BK: 2022 PG: 2967
 Recorded: 6/3/2022 at 1:18:02.0 PM
 County Recording Fee: \$7.00
 Iowa E-Filing Fee: \$3.13
 Combined Fee: \$10.13
 Revenue Tax:
 NAOMI ELLIS, RECORDER
 Marion County, Iowa

PREPARED BY & RETURN TO: SURVEYOR / McCLURE / 335 SE ORALABOR ROAD, ANKENY, IA 50021 / 515-512-1361

U.S. PUBLIC LAND SURVEY CORNER CERTIFICATE

REASON FOR PREPARING THIS CERTIFICATE:

- CORNER RESTORATION (ACCEPTED OR PERPETUATED CORNER)
- CORNER ESTABLISHMENT (PLSS CORNER CREATED, BUT NOT MONUMENTED IN THE ORIGINAL SURVEY)
- CORNER REESTABLISHMENT (LOST CORNER)

LAND SURVEY MONUMENT(S) SITUATED IN SECTION 35, TOWNSHIP 77 NORTH, RANGE 18 WEST
 OF THE FIFTH PRINCIPAL MERIDIAN, MARION COUNTY, IOWA.
 PREVIOUSLY RECORDED: INSTRUMENT# 2784 AND CORNER CERTIFICATE BOOK 2 PAGE 141

MONUMENTS DESCRIPTION AND REMARKS: FOUND 5/8" REBAR WITH YELLOW PLASTIC CAP # 14416 FROM THE RECORDED SURVEY IN BOOK 2021 PAGE 7019. THE SURVEY STATES THE CONCRETE MONUMENT UNDER THE FOUND REBAR. THE PREVIOUS CORNER CERTIFICATE STATES A CONCRETE MONUMENT.

PLAN VIEW
NO SCALE

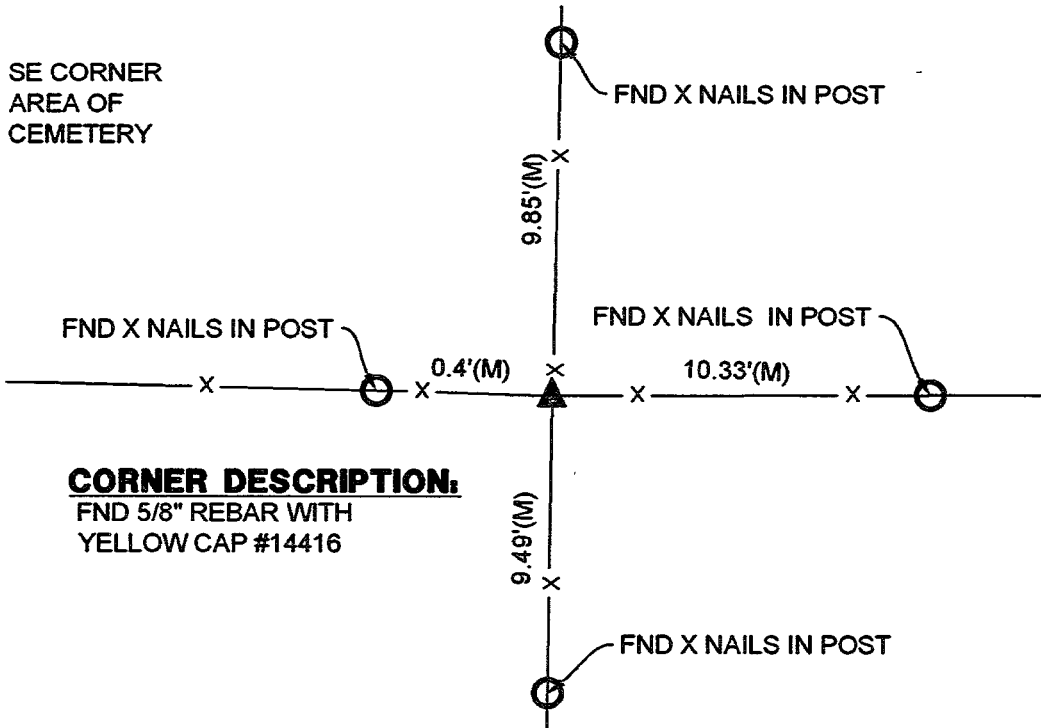
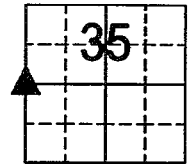

CORNER DESCRIPTION:
 FND 5/8" REBAR WITH
 YELLOW CAP #14416

CORNERS TO BE REFERENCED:

CORNER	QUARTER	SEC	TWP	RGE
SE	SE-NE	34	77	18
NE	NE-SE	34	77	18
SW	SW-NW	35	77	18
NW	NW-SW	35	77	18

IA RCS ZONE 9 COORDINATE:

N=7,629,606.13
 E=19,474,571.61

DRAWING PATH: P:\2022\0080\06-Drawing\Survey\Cor Cert - SW OF NW.dwg PLOT DATE: 06/2/2022 9:47 AM PLOTTED BY: MIKE LEE

1360 NW 121st Street, STE A
 Clive, Iowa 50325
 515-964-1229
 fax 515-964-2370

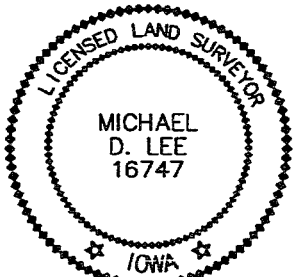
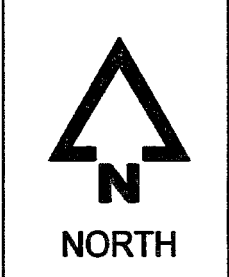

I HEREBY CERTIFY THAT THIS LAND SURVEYING DOCUMENT WAS PREPARED AND THE RELATED WORK WAS PERFORMED BY ME OR UNDER MY DIRECT PERSONAL SUPERVISION AND THAT I AM A DULY LICENSED LAND SURVEYOR UNDER THE LAWS OF THE STATE OF IOWA.

SIGNATURE: Michael Lee DATE: 6/2/2022
 MICHAEL D. LEE

MY LICENSE RENEWAL DATE IS DECEMBER 31, 2022
 PAGES OR SHEETS COVERED BY THIS SEAL: THIS SHEET

DATE SURVEYED: 02 / 09 / 2022

Found Conc. Monu. 2' deep, also found "x" nails
 grown in 1939 reference trees (3), ties checked.
 Accepted position. No Certificate of record.
 Set 5/8 x 18" orange plastic capped pin,
 # 7995 on E. side of Monu.

Brian Morrissey 5/26/00

E. 1/4 Cor sec. 34-77-18

Set = Nov-13-1939

Notes: Thomas, Elsberry, Harpers,
 Koonts, Shore, Eddington

