

Found Large Granit Rock
18" x 18" x 10" over 2-2 1/2" A Tile

set c.m. over one A tile
" Rock on top c.m. North side

c.m. 17" under surface

E 1/4 cor 10-77-19
Set- 10-24-40
Notes- Kennedy
Party- Shore-Mitchell

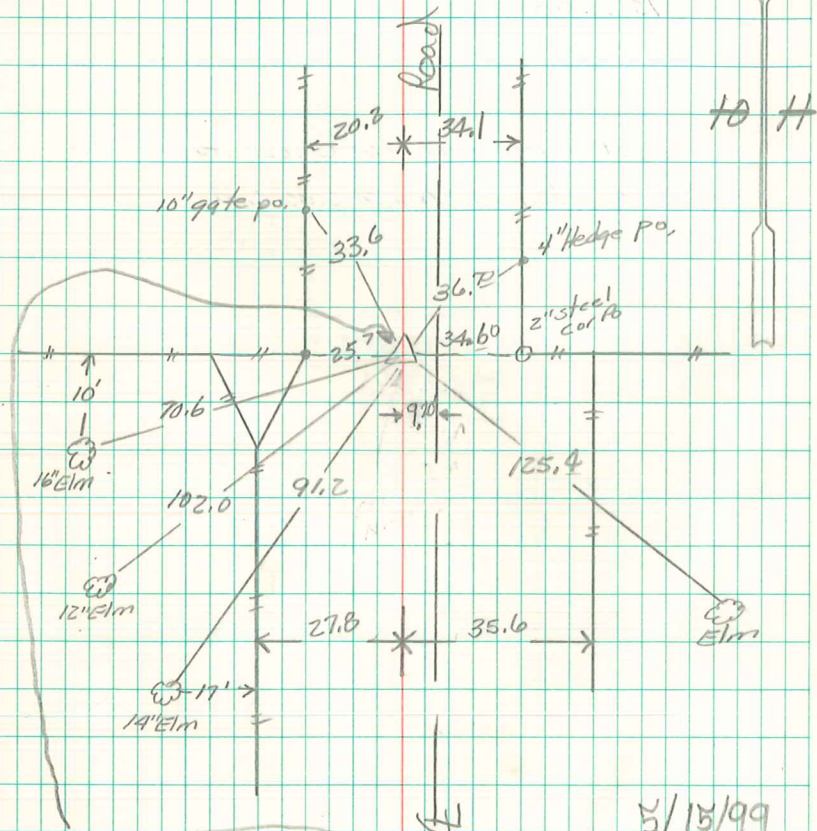

Found CM with 8" of top
Broken off. Reset top of CM
on top of base. Set 1" iron
Pipe w/cap on S. side CM 6" deep.

5/15/99
Abie Davis