

INDEX LEGEND

COUNTY: Marion
SECTION: 21, T-77N, R-19W
CORNER: SW Cor. of the SE 1/4 of the SE 1/4

SURVEYOR & SURVEY COMPANY:
Jason S. Lowry, P.L.S.
Lowry Land Services, L.L.C.
752 Diamond Trail Rd., Searsboro, Iowa 50242

PREPARED BY AND RETURN TO:
Jason S. Lowry, P.L.S.
752 Diamond Trail Rd., Searsboro, Iowa 50242
(641) 521-1160, lowrylandservices@gmail.com

Instr. Number: 24-1182
BK: 2024 PG: 1182
Recorded: 4/1/2024 at 11:51:45.0 AM
County Recording Fee: \$7.00
Iowa E-Filing Fee: \$3.00
Combined Fee: \$10.00
Revenue Tax: \$0.00
NAOMI ELLIS, RECORDER
Marion County, Iowa

UNITED STATES PUBLIC LAND SURVEY CORNER CERTIFICATE

Land Survey Monuments situated in Section 21, Township 77 North, Range 19 West of the Fifth Principal Meridian, Marion County, Iowa. Previously recorded in Book 2006, Page 6396 in the Marion County Recorder's Office.

MONUMENT DESCRIPTION & REMARKS

SW Cor. SE 1/4 SE 1/4 - Previously recorded certificate called for U.S. Army Corps of Engineer's monument #357.3. Searched and did not find said monument. Appears to have been removed when drainage ditch was dug out. Set 5/8" x 18" pink plastic capped rebar, P.L.S. #22291 using remaining ties. Previous monument not found.

This corner was used for an easement survey in the SE 1/4 of the SE 1/4 of Section 21.

PLAN VIEW

No Scale

SW Corner
of the SE 1/4
of the SE 1/4
Section 21

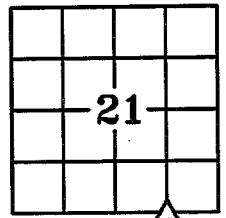

Set 5/8" x 18" pink plastic capped rebar, P.L.S. #22291

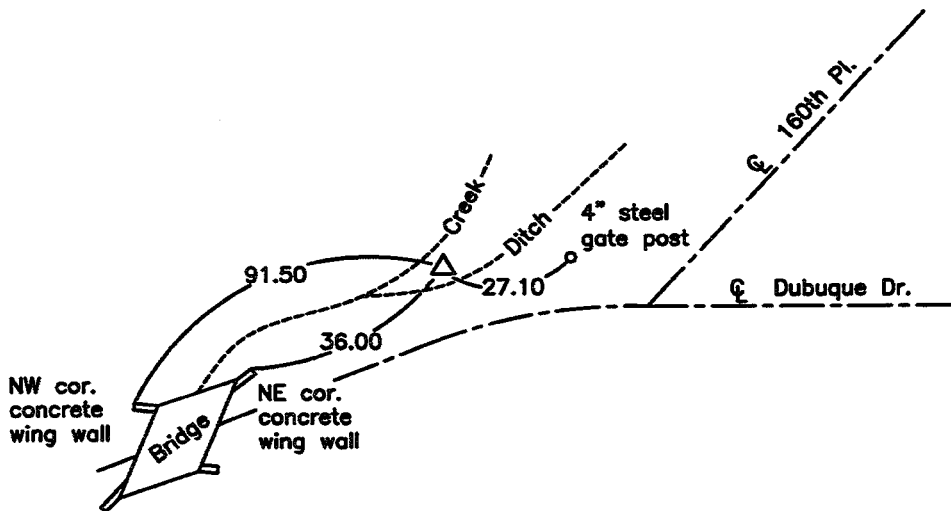

NOTE: ALL TIES ARE PLUMB MEASUREMENTS TO ORANGE SURVEY MARKER UNLESS NOTED.



I hereby certify that this land surveying document was prepared and the related survey work was performed by me or under my direct personal supervision and that I am a duly Licensed Land Surveyor under the laws of the State of Iowa.

My license renewal date is 12/31/2025

Pages covered by this seal: 1 - 1

LEGEND

- ▲ Section Corner Found
- △ Section Corner Set
- Existing Fence

LAND CORNERS TO BE INDEXED

Land Corner	Section	Township	Range
SW Corner SE 1/4 SE 1/4	21	77	19

Jason S. Lowry
Jason S. Lowry

03/26/2024

Iowa Lic. No. 22291

Date

LOWRY LAND SERVICES, L.L.C.

752 DIAMOND TRAIL RD., SEARSBORO, IOWA 50242, 641-521-1160

PROJ. NO. 2124

DATE OF SURVEY: 03/20/24

CERT NO. 1/1