

Found 3-3" Tile Concrete Filled  
TOP Tile Broken

Set C.M. over 3" Tile

C.M. 11" Below Surface

N.E. Cor 7-77-19

Set - 10-25-40 E 1/4 Cor

Notes = Wignall Sec 6

Party = Kennedy shore & Mitchell

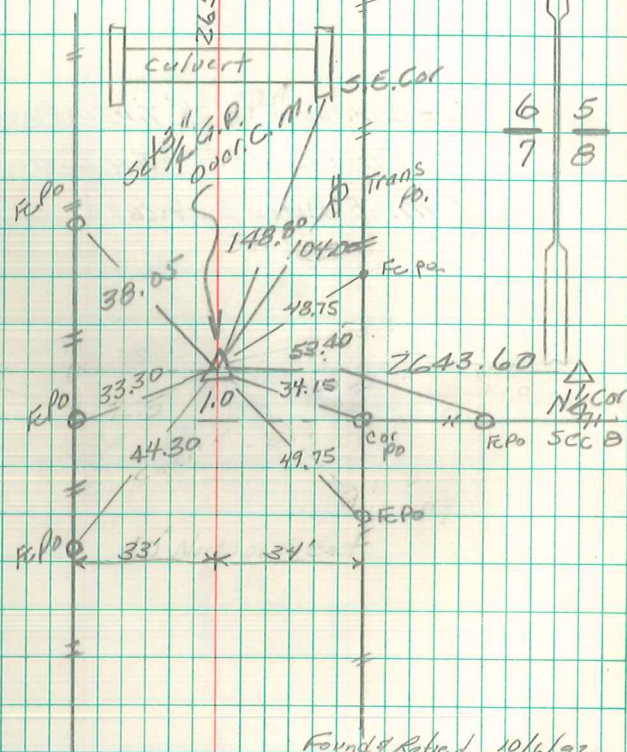

Found & Retied 10/6/92  
DUANE MEYER