

Found 4-3" Tile Filled with Concrete,  
& Pieces of Broken Tile

Left Evidence as we Found it,  
set C.M. on North side over 1-3" Tile

Top C.M. 12" Below old Road bed.

N. 1/4 Cor Sec 34-77-21

Set 10-9-1990

Notes: Kennedy, Wells, Burns  
& Crozier, Hewitt.

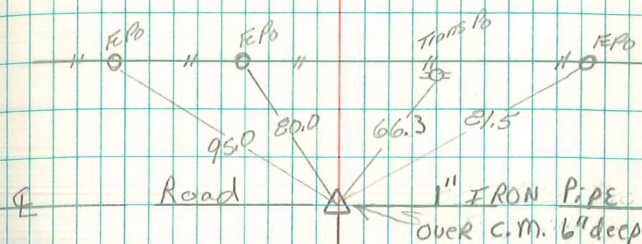

27  
34

Retied 9-14-94/  
ABIE C. DAVIS