

N⁴ Corner 6-77-21

3/23/12 - Notes: Searched area using Jasper County ties, Metal Detector, Probe 78-21 Rod, & shovel dug various holes with no monument found.

- Set 1/2" Rebar with yellow plastic cap #19710 using the intersection point of the fence line to the west & the centerline of the vacated dirt road.

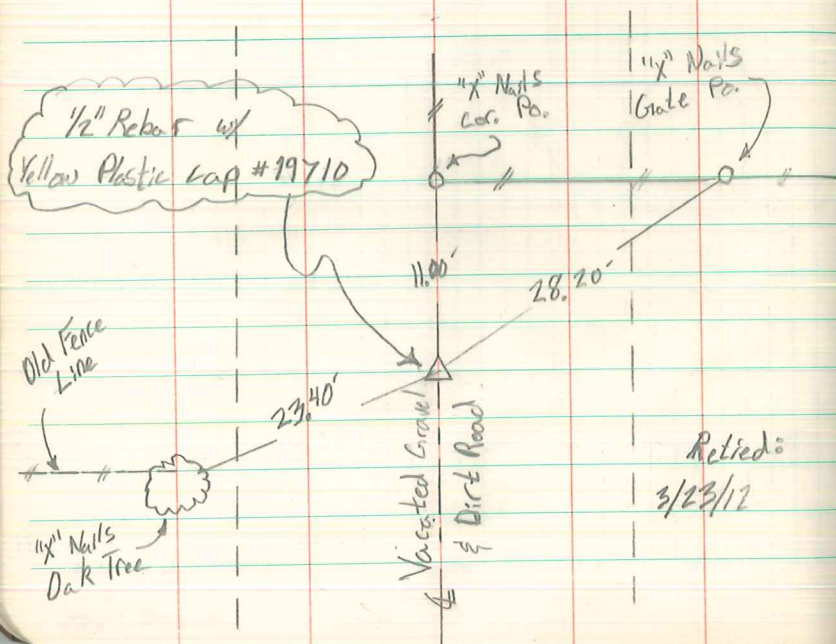

Retied:
3/23/12

N¹/₄ Cor 6-77-21
From Jasper County Records
2-26-63

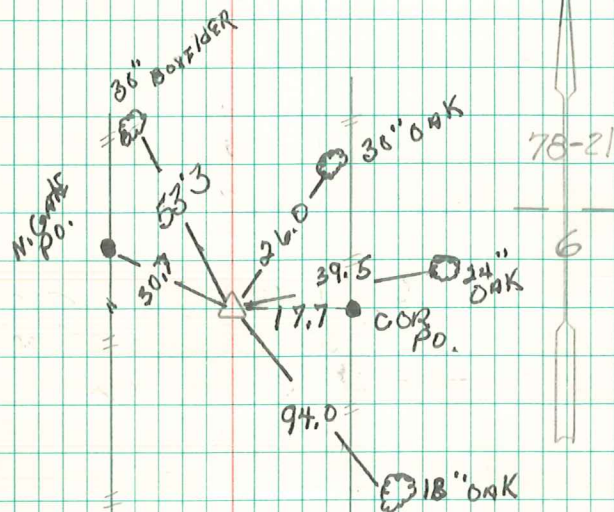

53.3' N. to x Nails in 30" Bay Elder
39.5' E. to " " " 24" oak
30.7' NW to " " " N. Gate Post
26.0' N.E. to Blazed 30" oak
17.7' E. to Corner Post
94.0' S.E. to Blazed 18" oak

← New Tie